

FREECURVE | SERVICE MANUAL

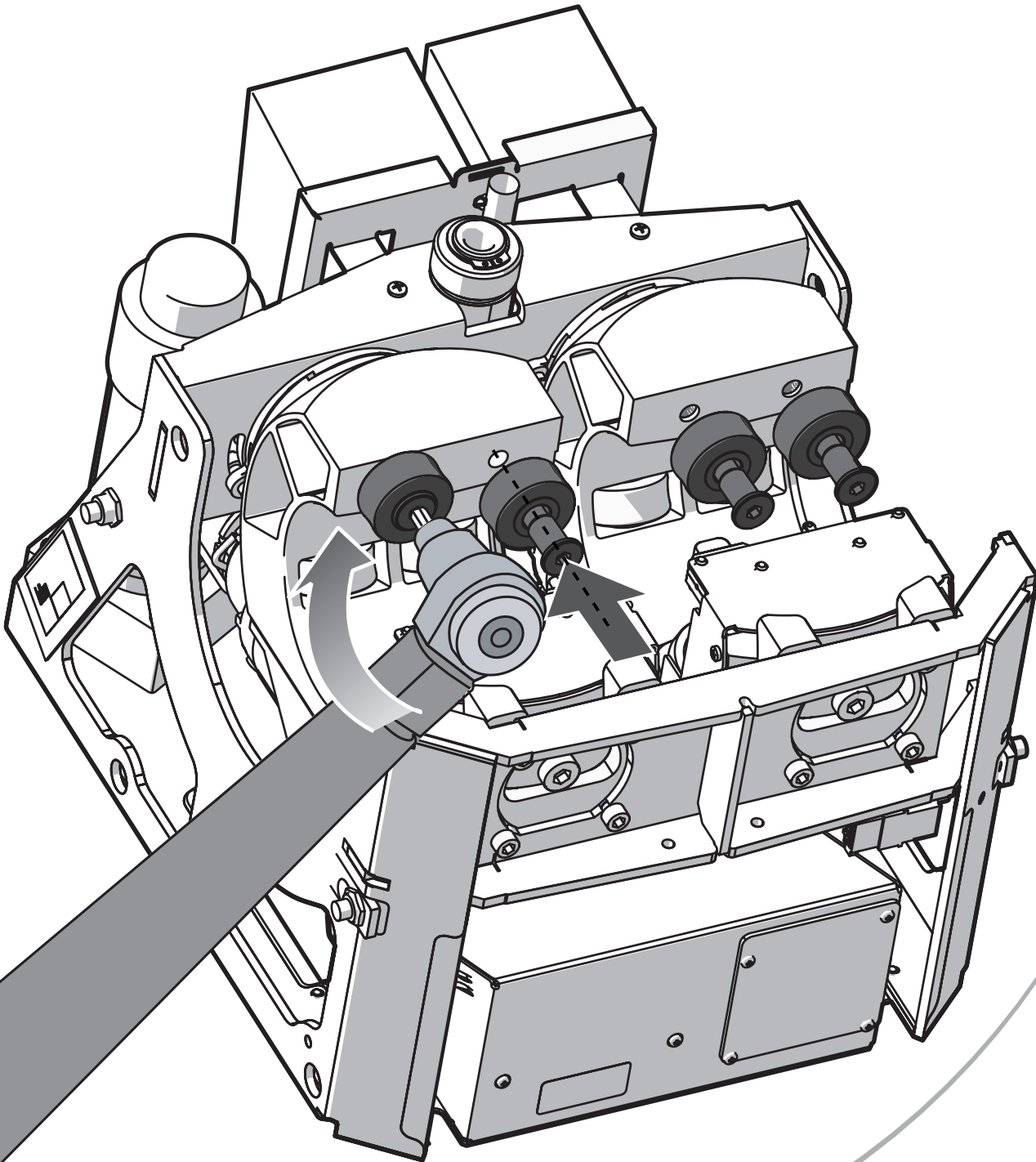

11P00342, Revision S



handicare

All rights reserved. No part of this publication may be reproduced and/or published by means of print, photocopy, microfilm or in any other way or form, without prior written permission from the manufacturer. This also applies for the accompanying drawings and diagrams. The manufacturer reserves the right to change parts at any time, without prior or direct notification to the customer. The contents of this manual may also be changed without prior warning. This manual is intended for the standard models of the lift. The manufacturer therefore cannot be held liable for any damage resulting from specifications that differ from those of the standard model of the lift supplied to you.

This manual has been compiled with the best intentions and every possible care but the manufacturer cannot accept responsibility for any errors in this manual or for the consequences thereof.

REQUIRED TOOLS & DOCUMENTS

5-50Nm

TECHNICAL MANUAL

handicare ACADEMY

Certificate for Han di Care
who has attended and successfully completed the technical training course for Freecurve
Andy van Leeuwen
Certified trainer Handicare

Art.nr. 11J00084

Art.nr. 11J00114

Art.nr. 11J00060

CHROME INTELLIGENT BATTERY TESTER
Simulates full battery discharge test in seconds
Tests 12V and 24V Car batteries from 1.2Ah - 100Ah

OFF
Turn off the lift, before the service work is started

Turn off and lock the switch, before the service work is started

The Dutch manual is the original language

S

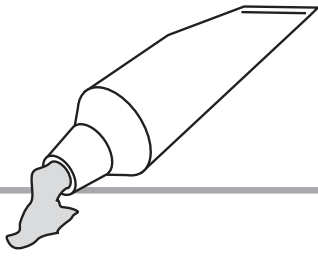

Only a certified technician shall service this lift (general required knowledge can be found in the Freecurve Technical Manual). The latest service instructions of the lift are available for download at www.handicarepartners.com. Routine, Periodic, and Acceptance inspections and test in the USA shall be done according to ASME A18.1-2017 chapter 10 and 11.



Check visually



Check dirt and clean [no sandpaper]



Check for damage



Check lubrication



Check function



Check for wear



Check tightness of bolts and screws

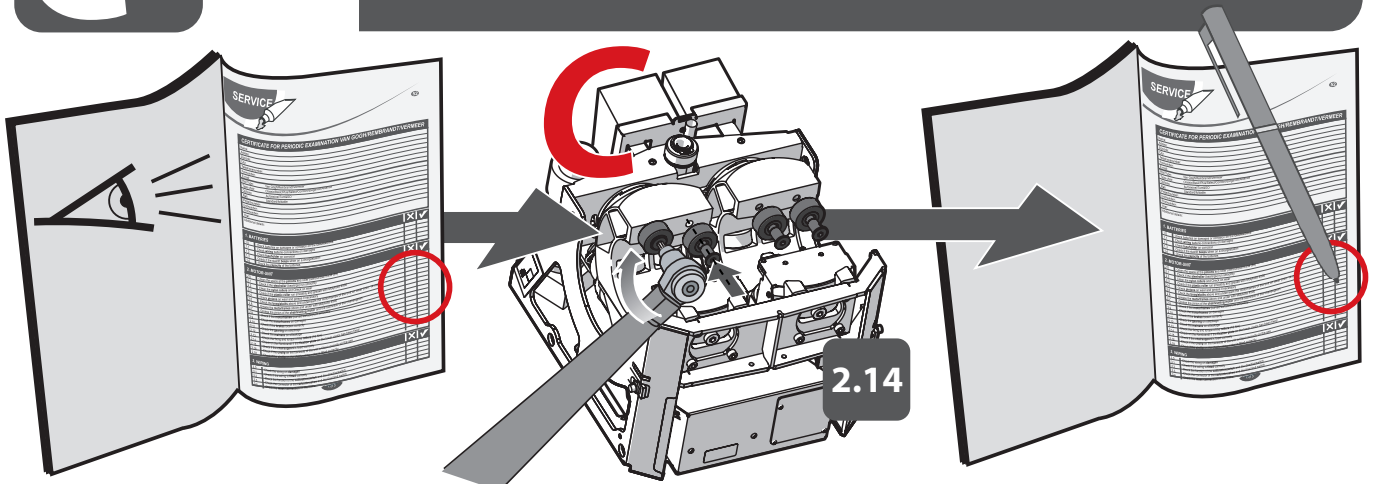

S

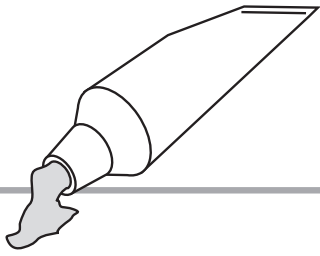

Checklist is on page 14

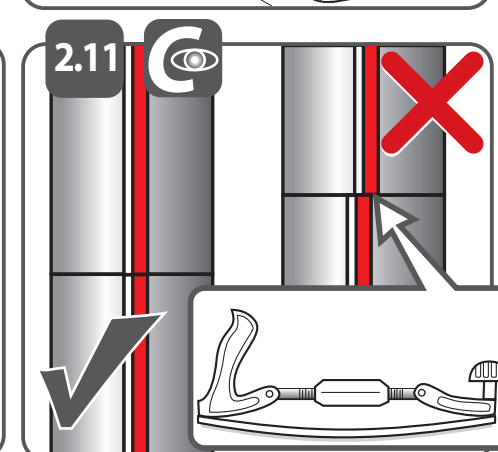
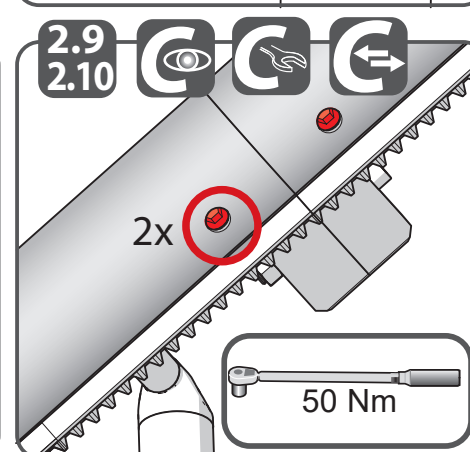
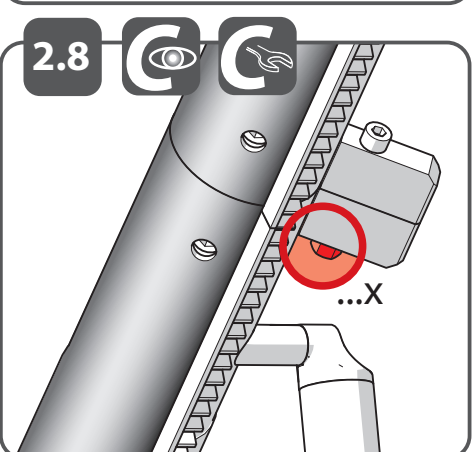
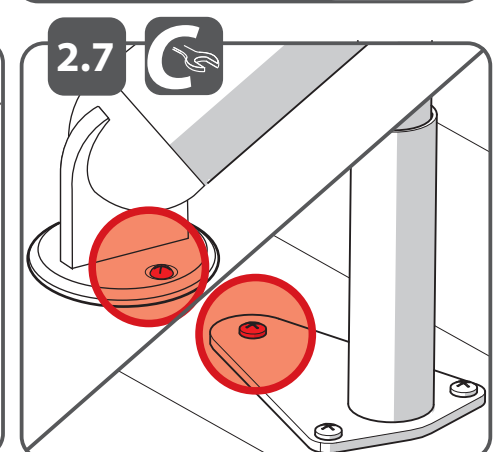
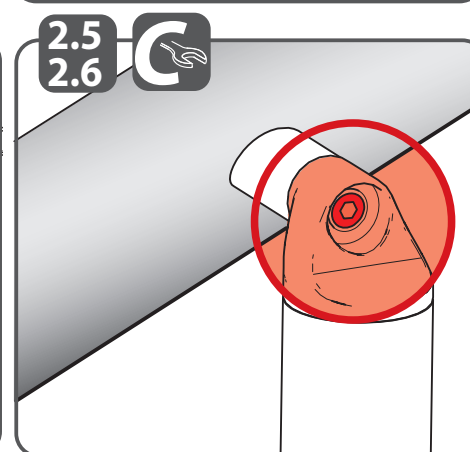
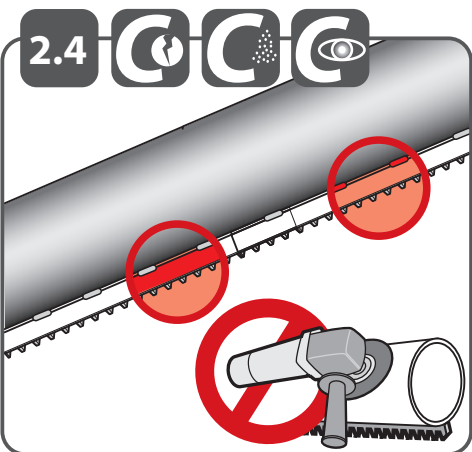
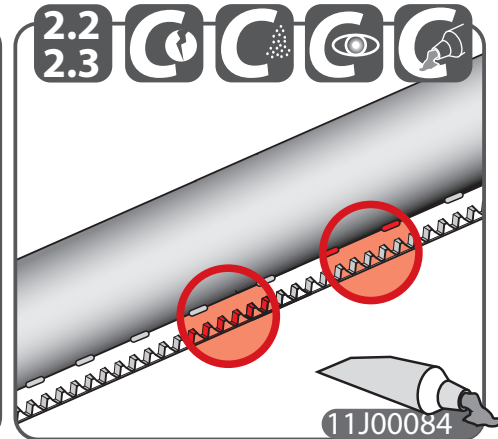
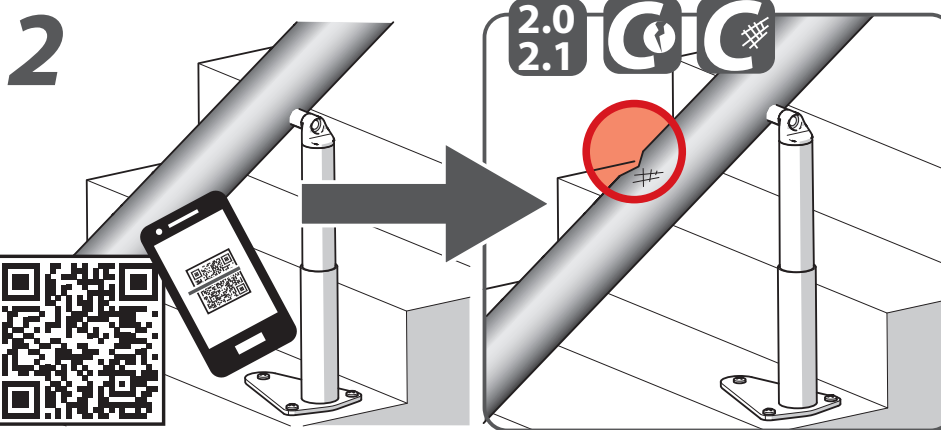
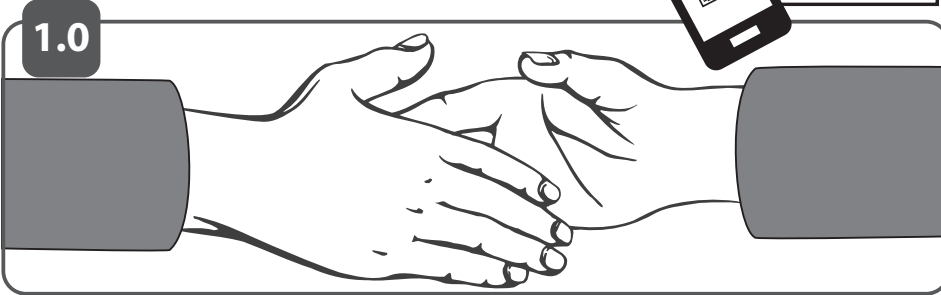

S

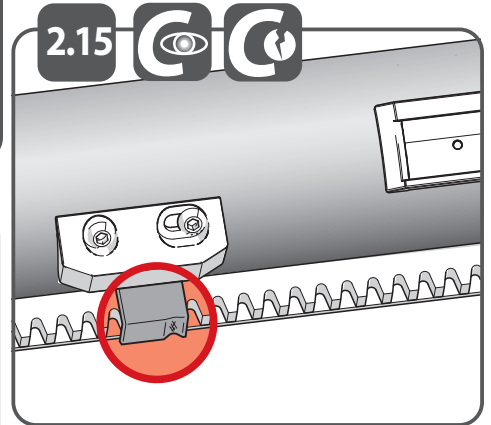
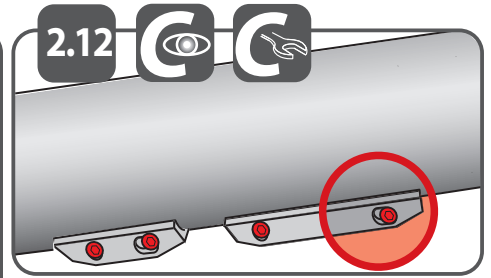
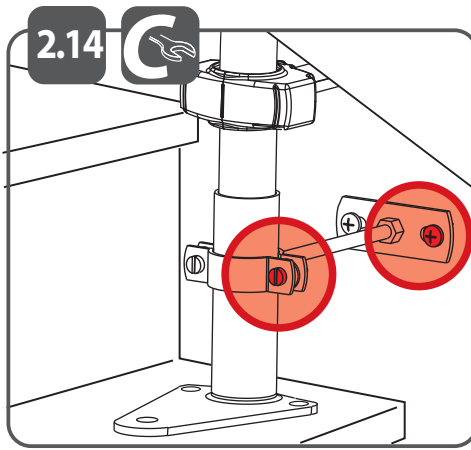
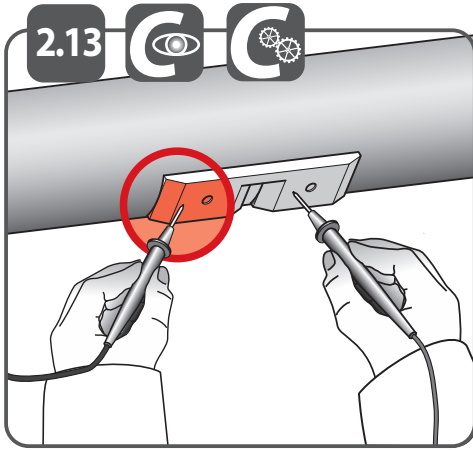
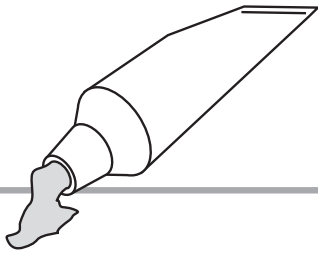

3

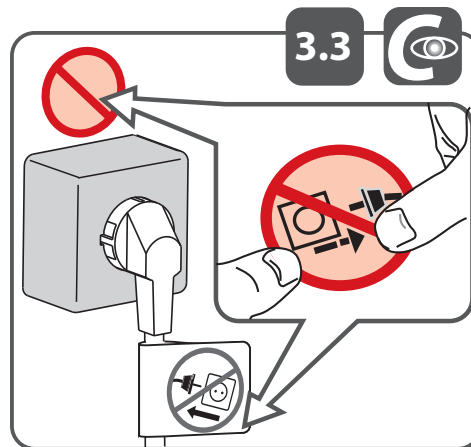
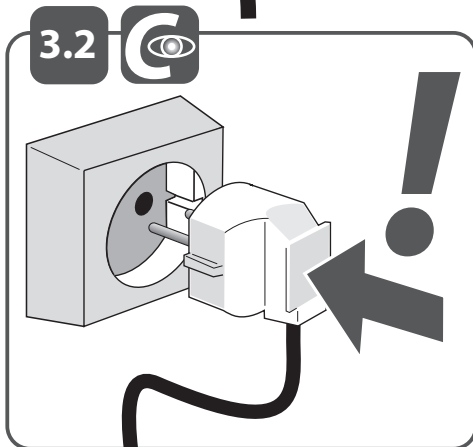
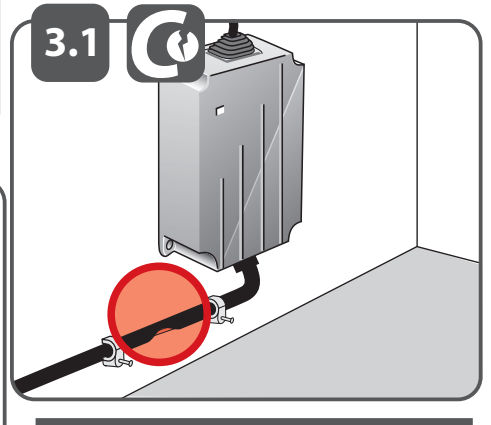
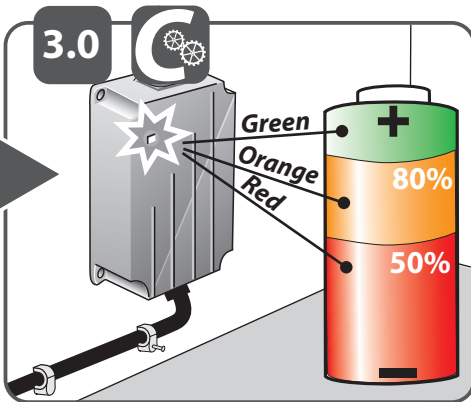
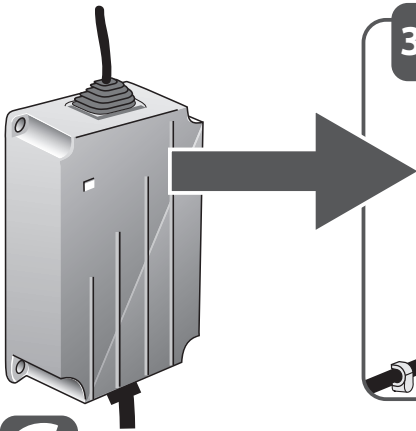

4

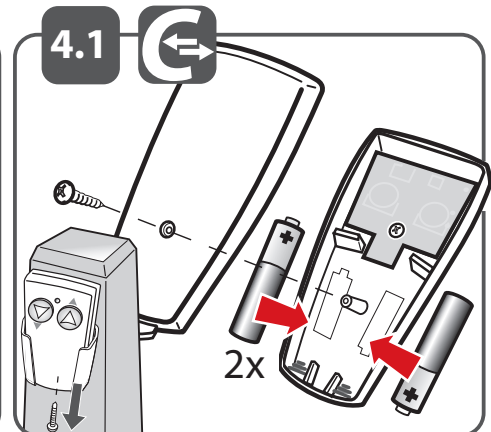
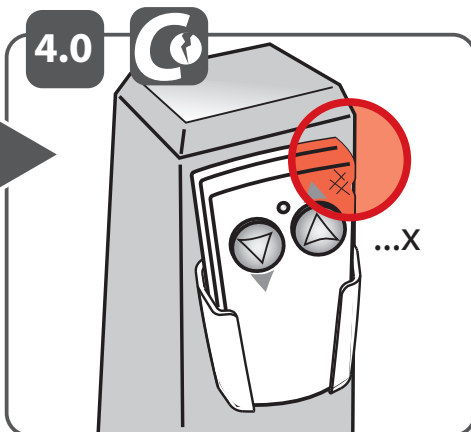
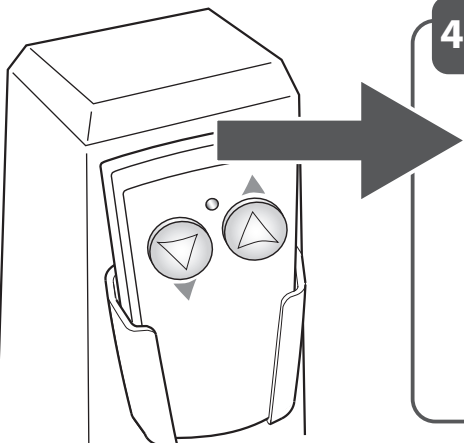

S

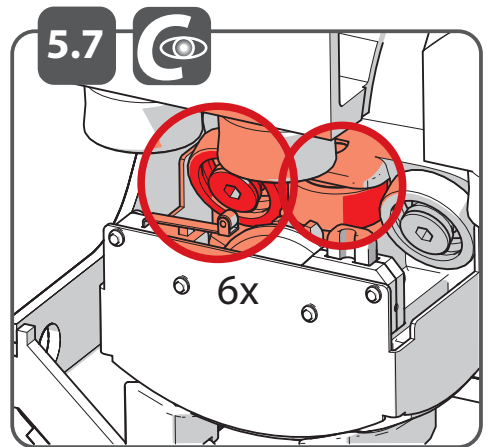
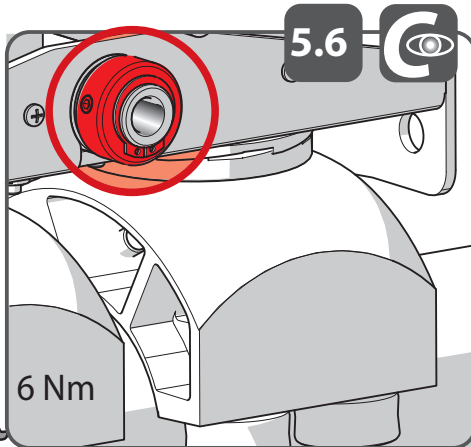
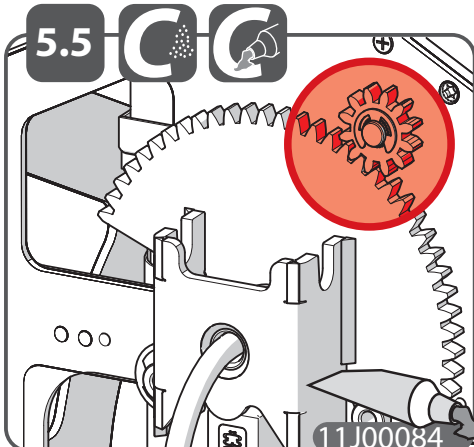
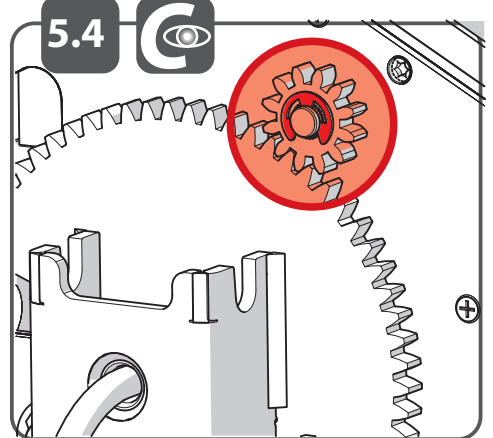
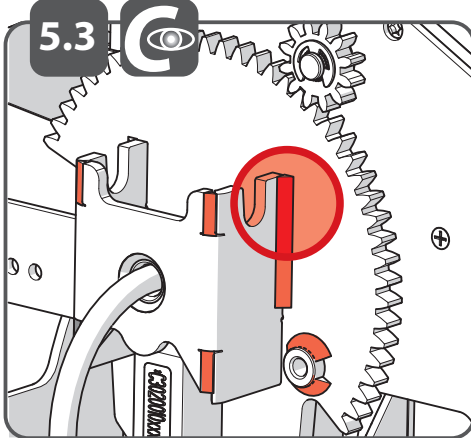
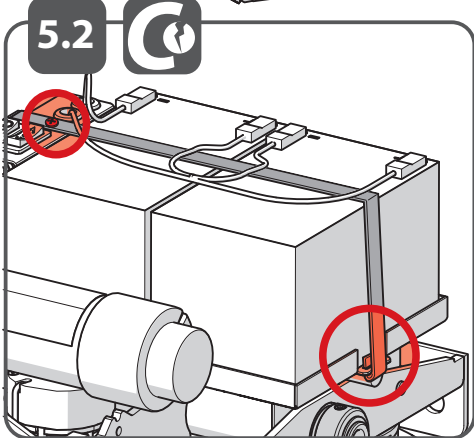
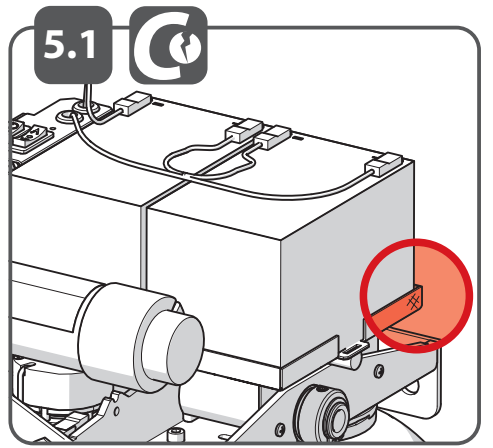
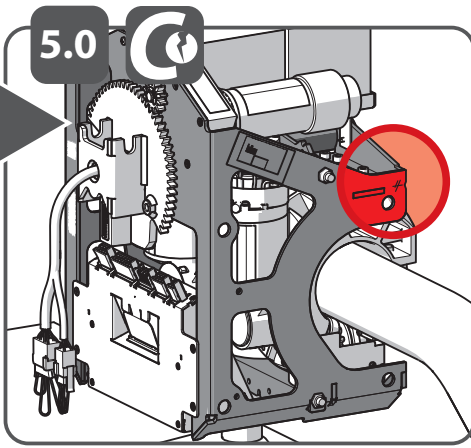
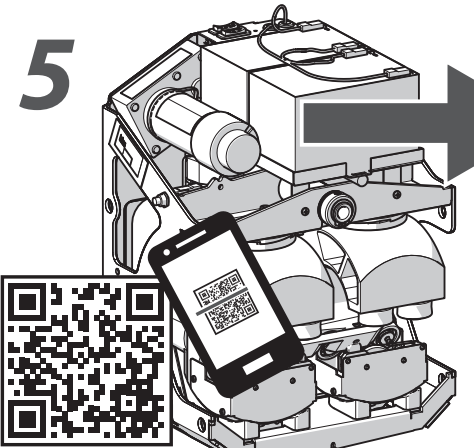
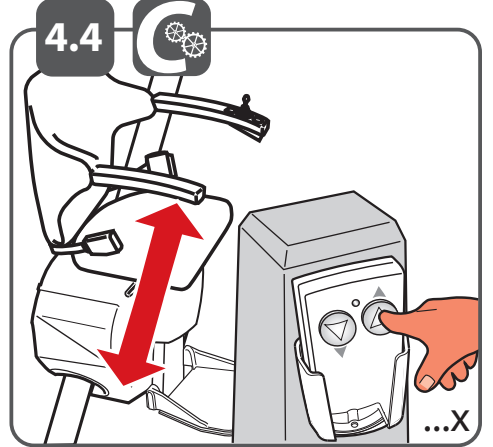
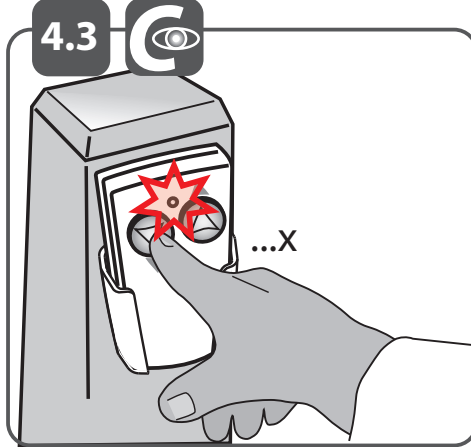
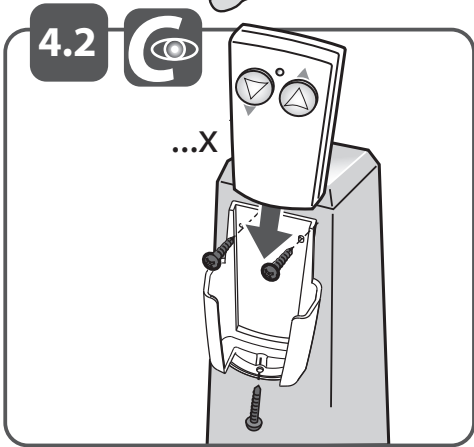
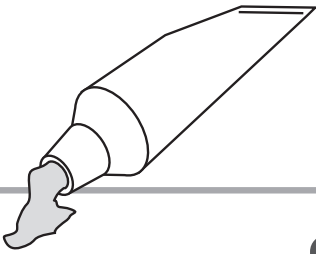

S

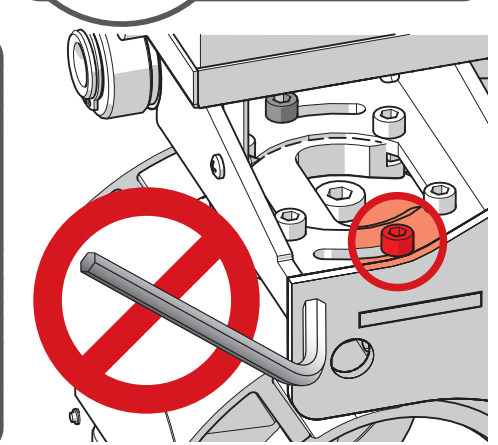
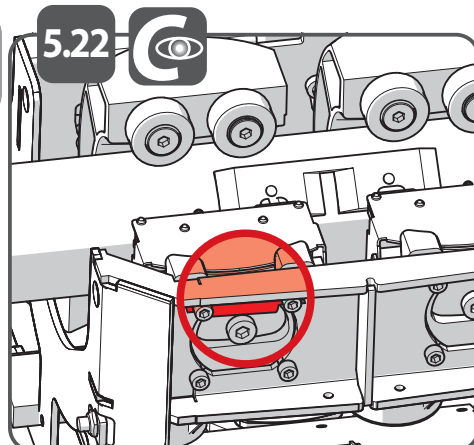
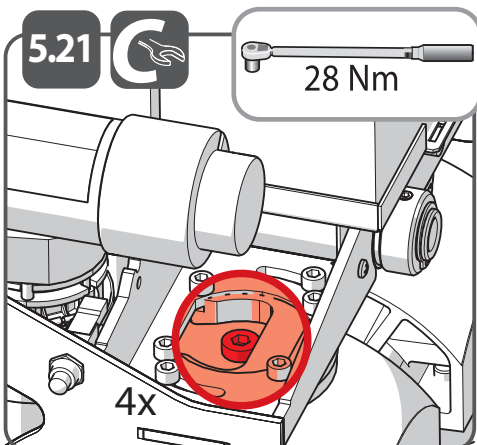
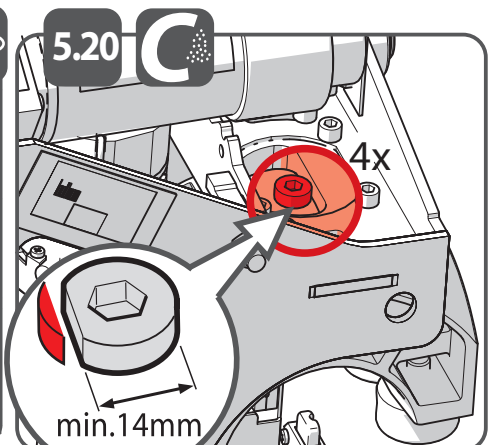
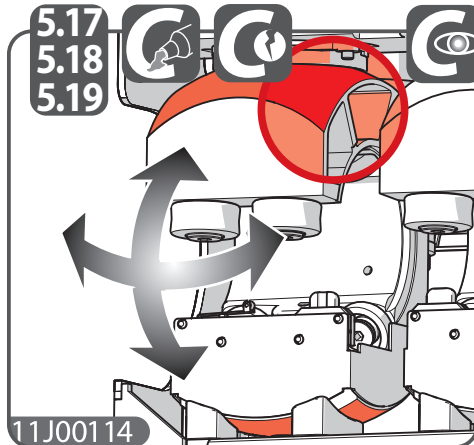
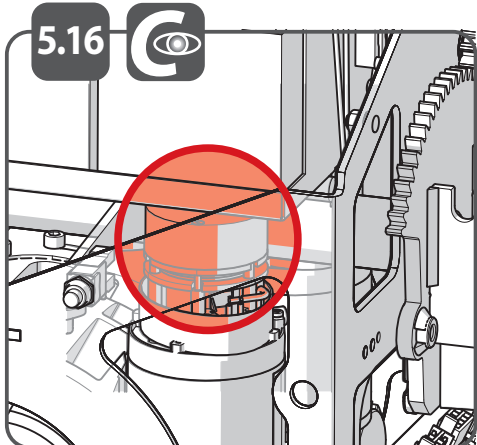
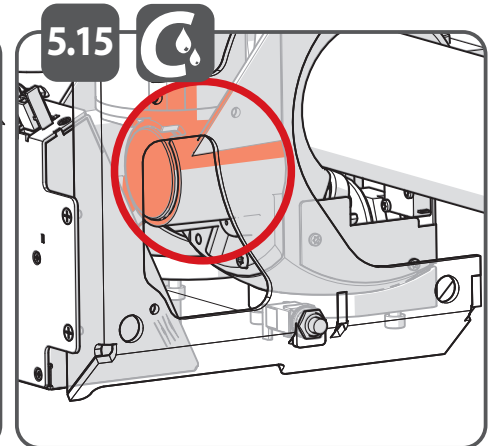
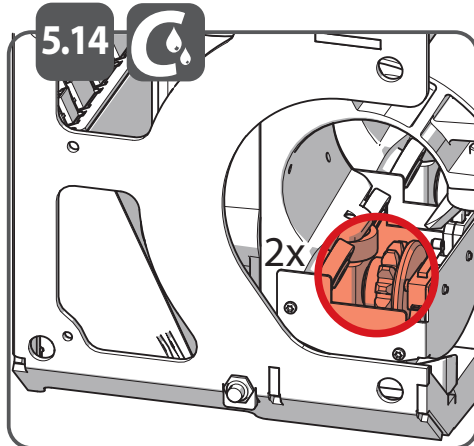
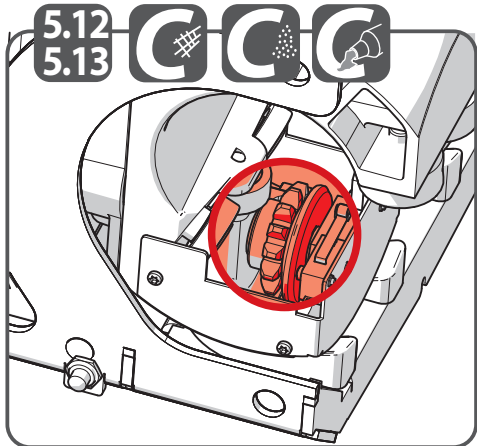
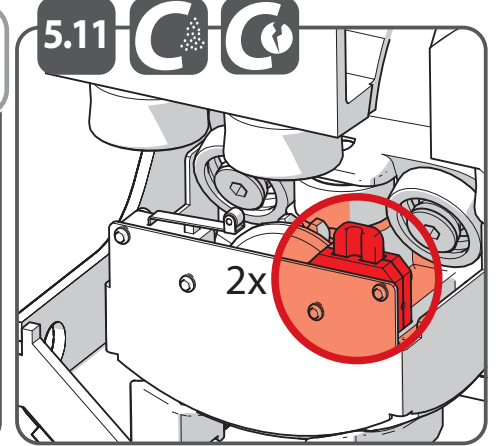
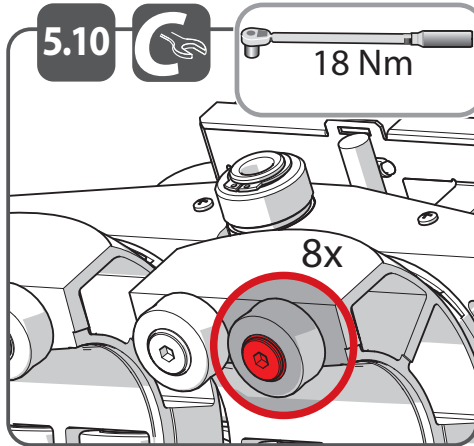
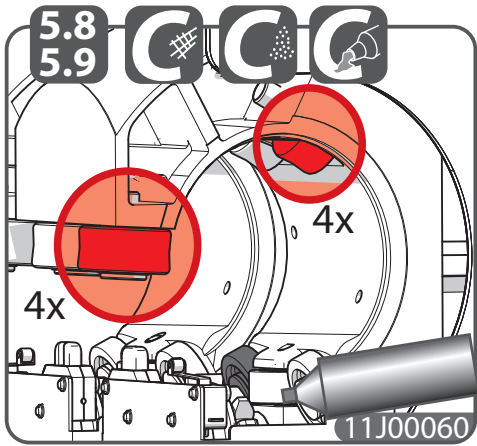
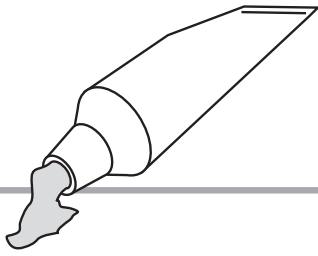

S

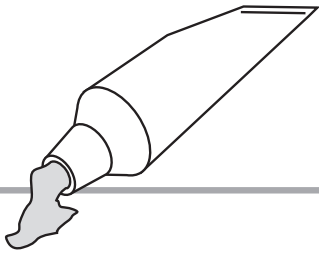

6

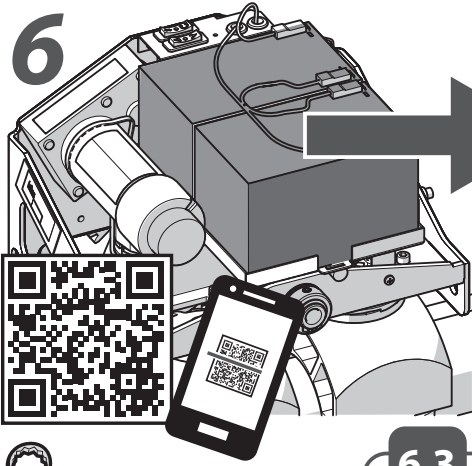

6.0
6.1

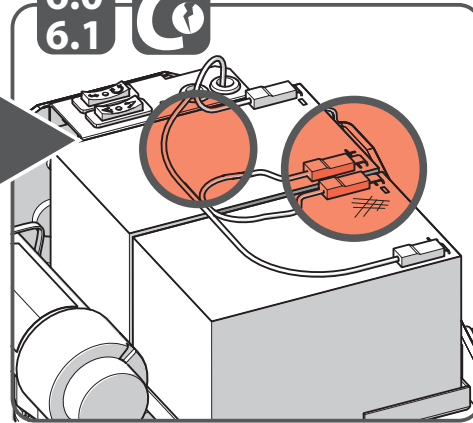

6.2

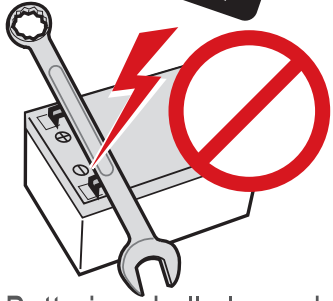
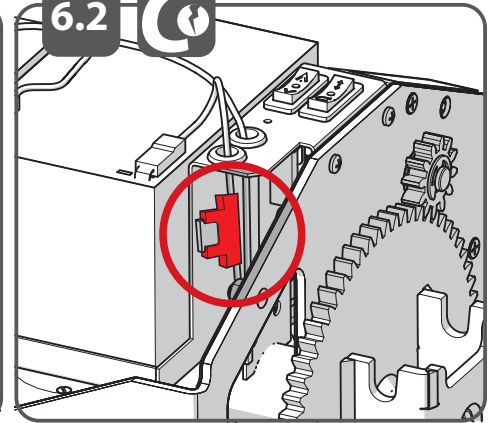

Batteries shall always be replaced by batteries of the original specifications.

6.3

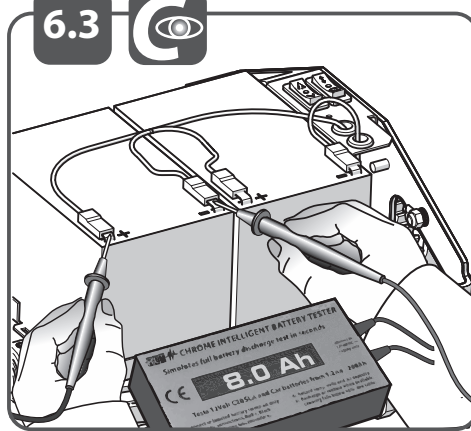

Liquimolly Battery clamp grease
RS Pro contact treatment grease 503-335

In a humid environment, the spray below can be applied to prevent oxidation of the battery contacts.

6.4
6.5

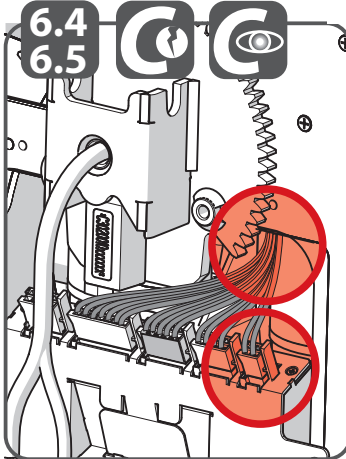

6.6

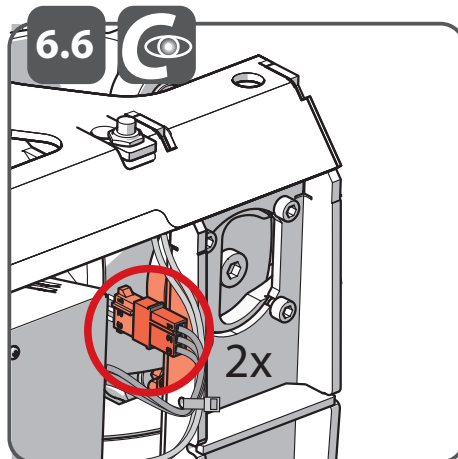

6.7

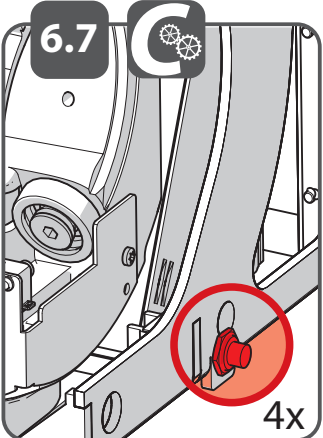

6.8

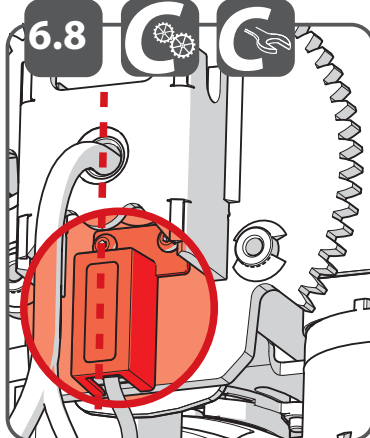

6.9

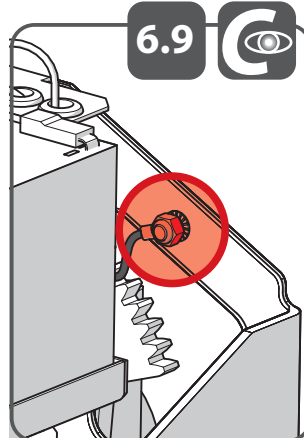

6.10

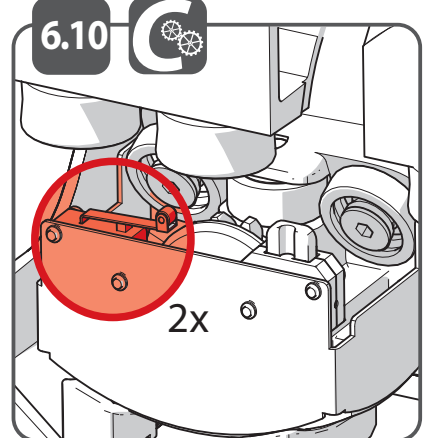

S

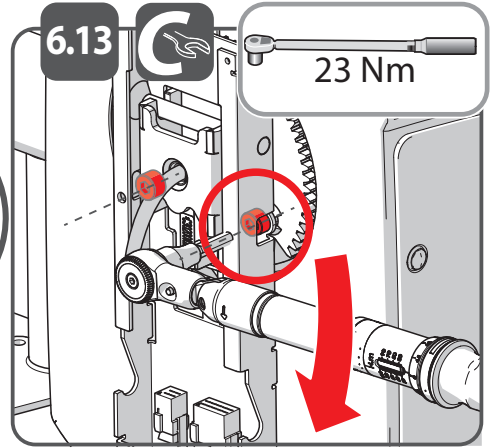
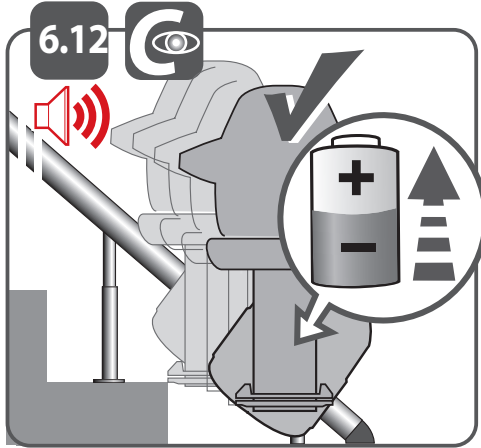
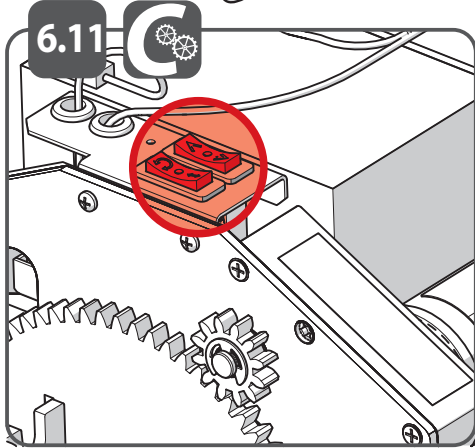
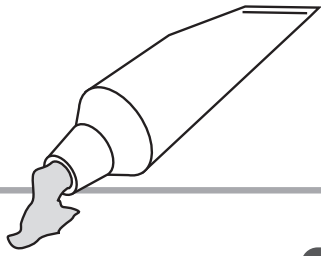

S

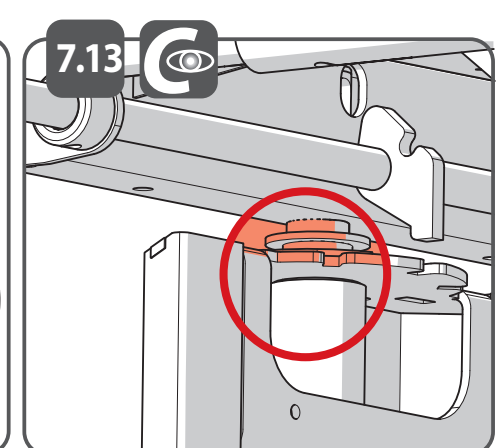
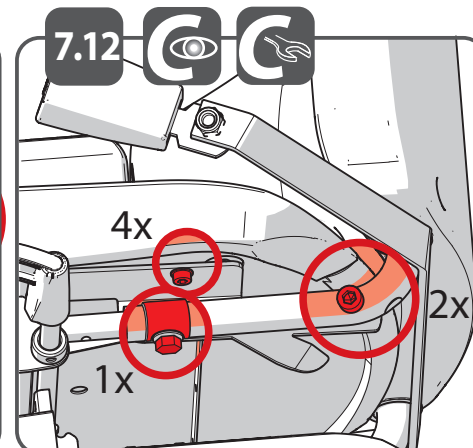
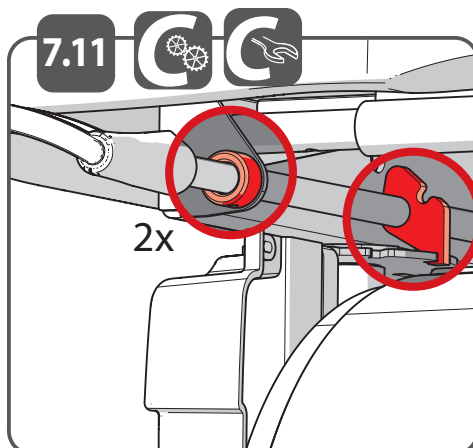
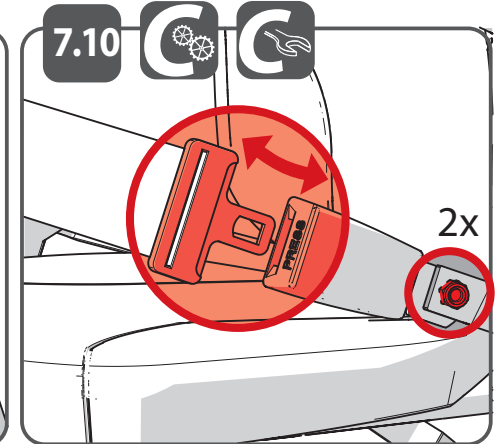
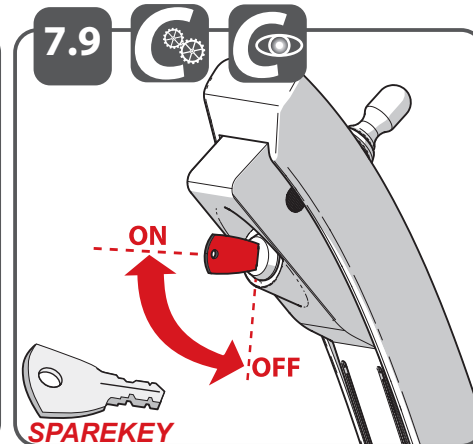
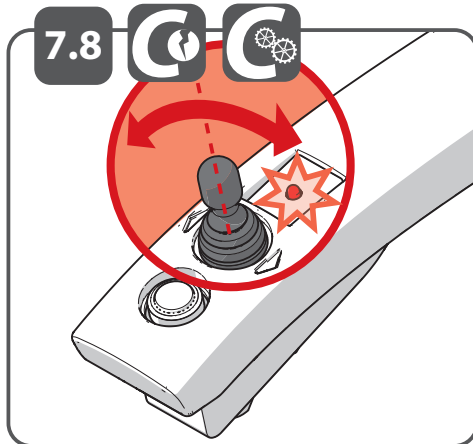
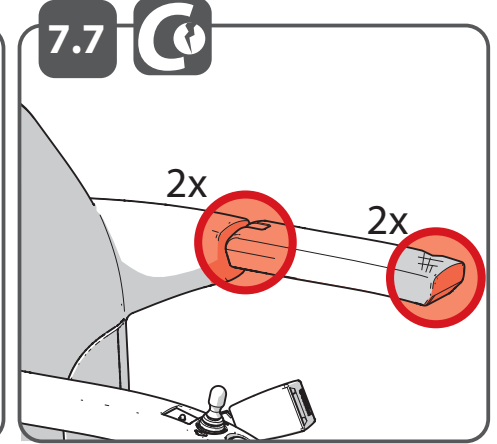
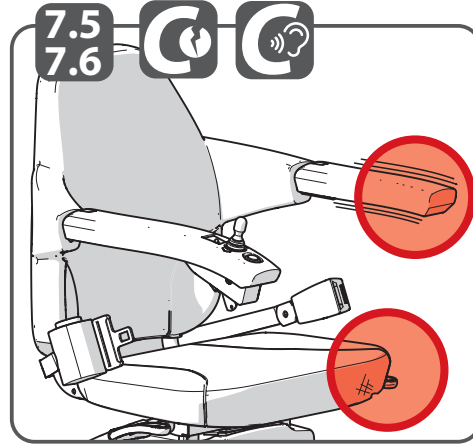
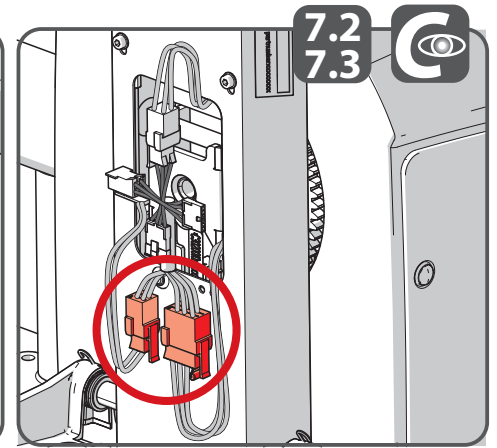
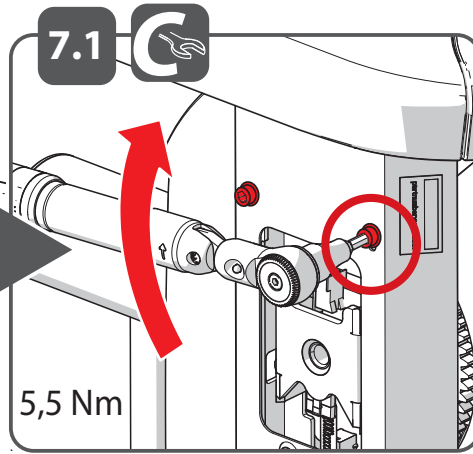
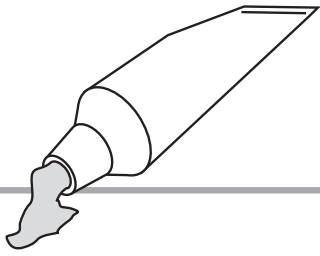

S

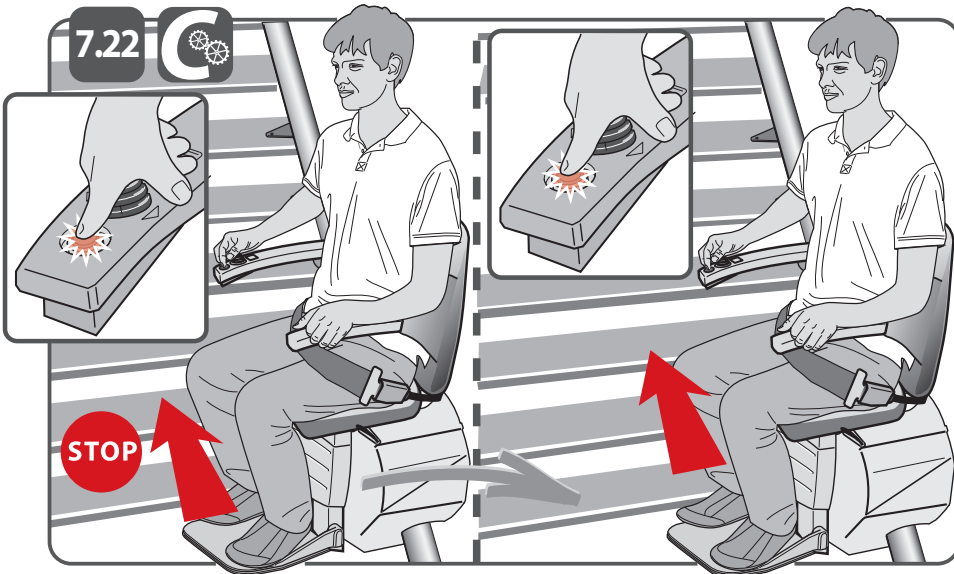
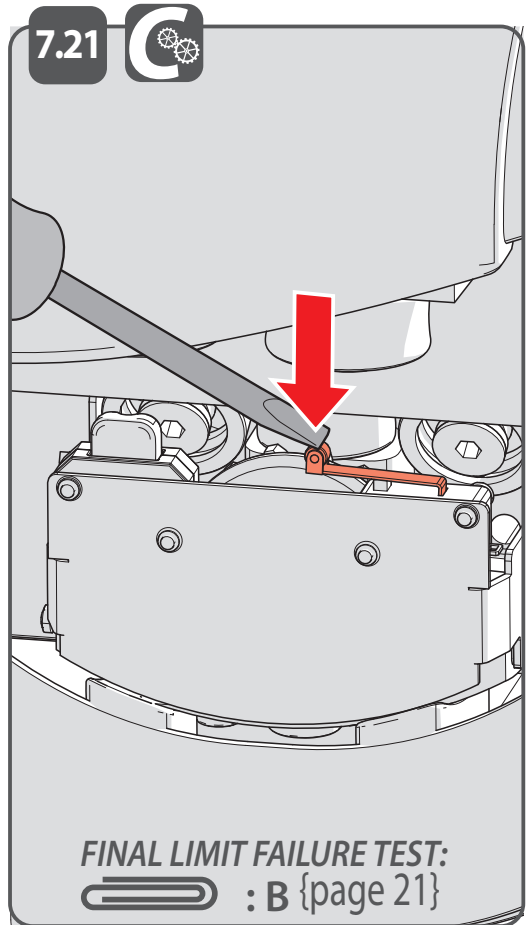
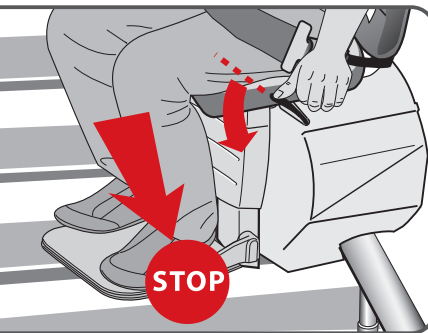
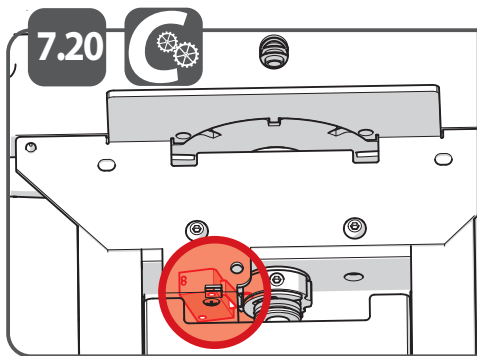
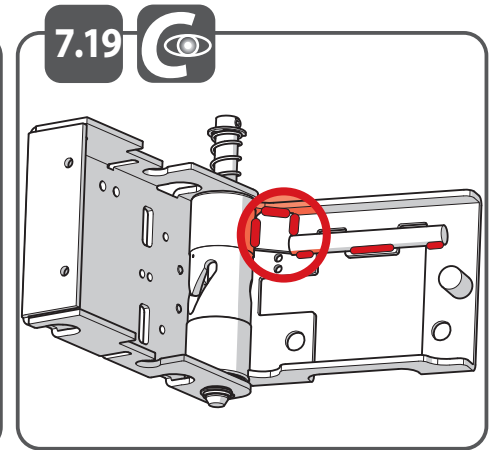
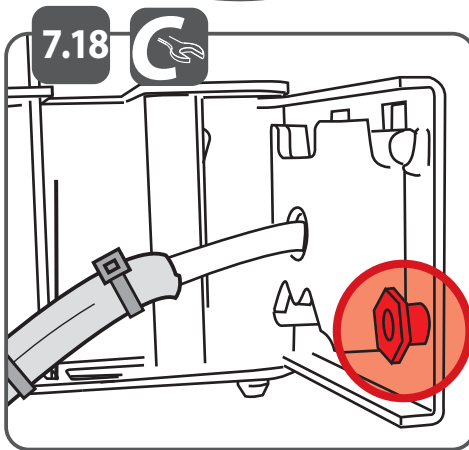
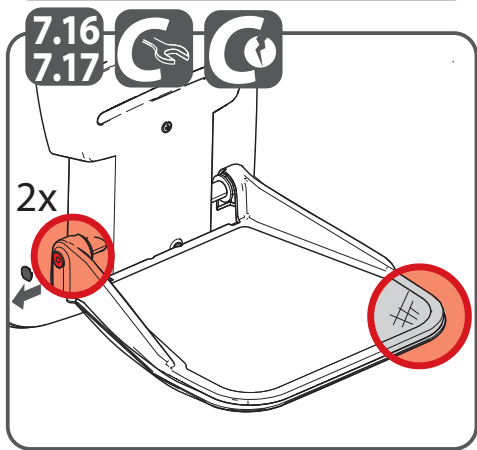
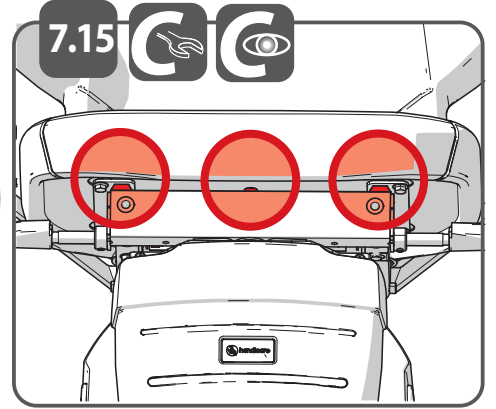
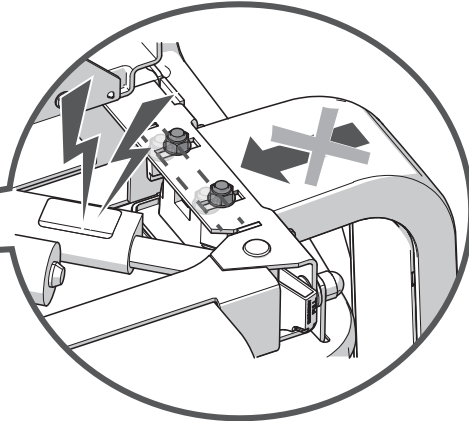
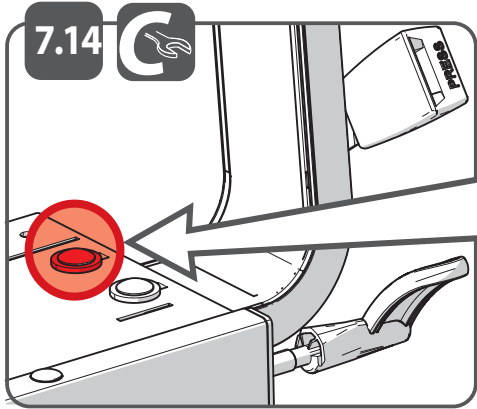
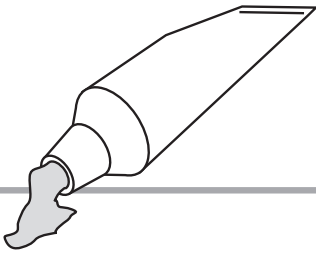

S

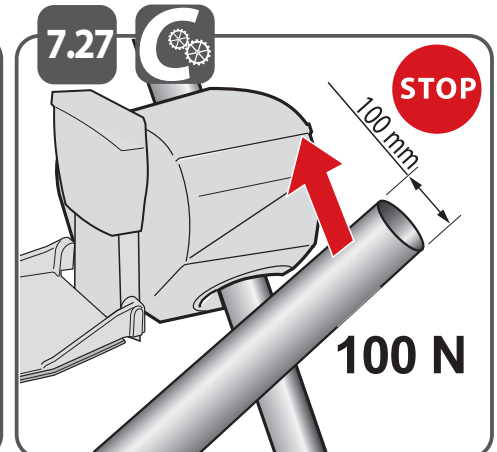
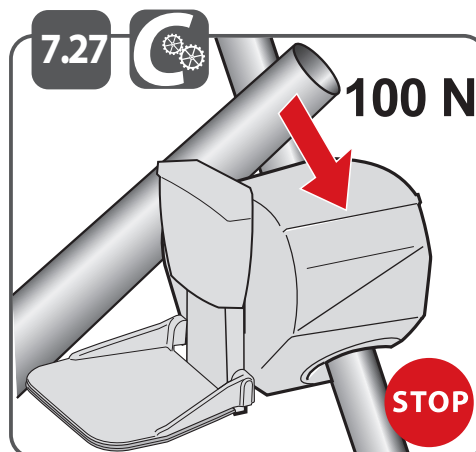
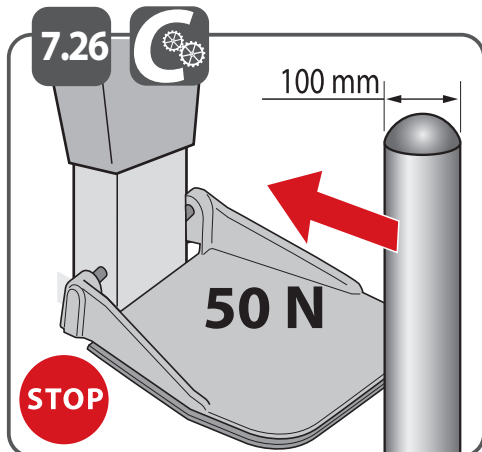
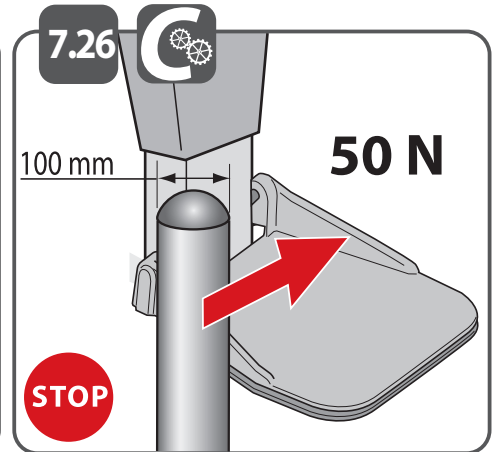
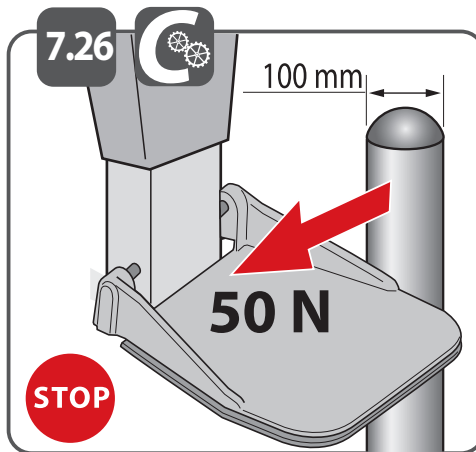
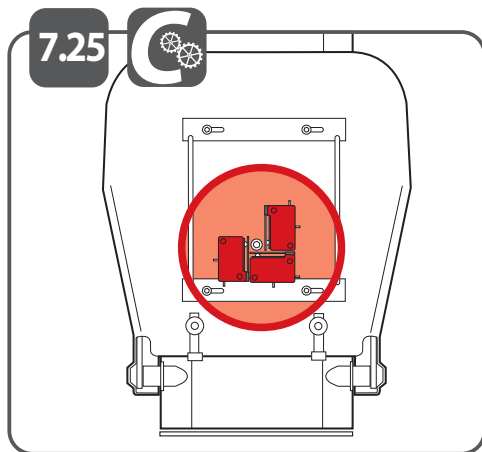
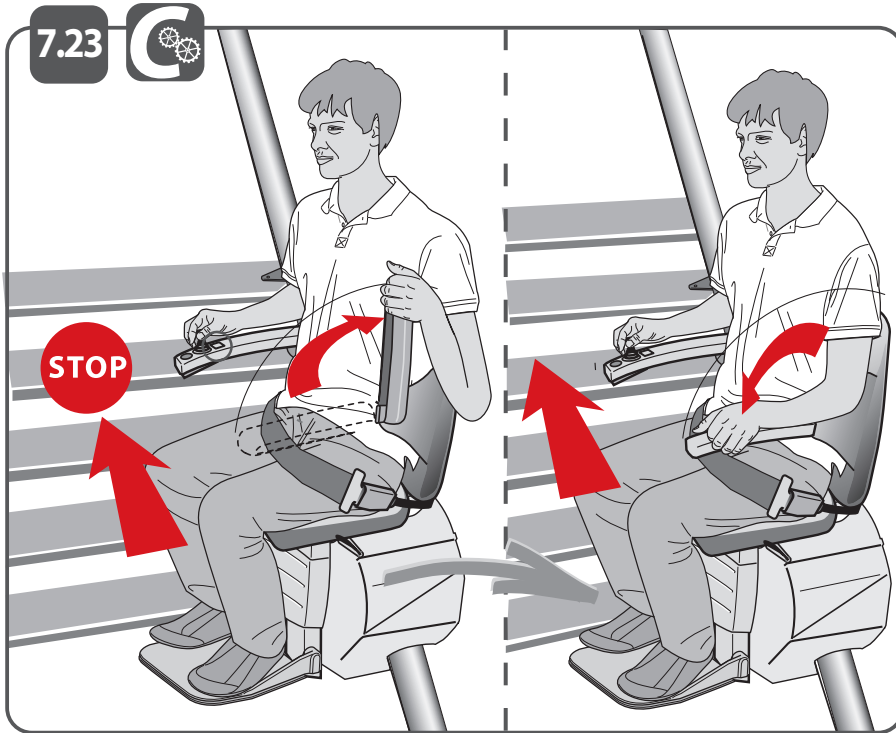
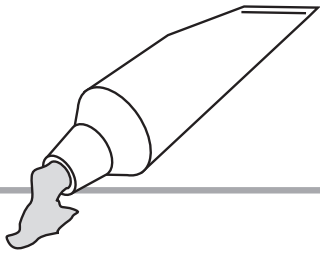

S

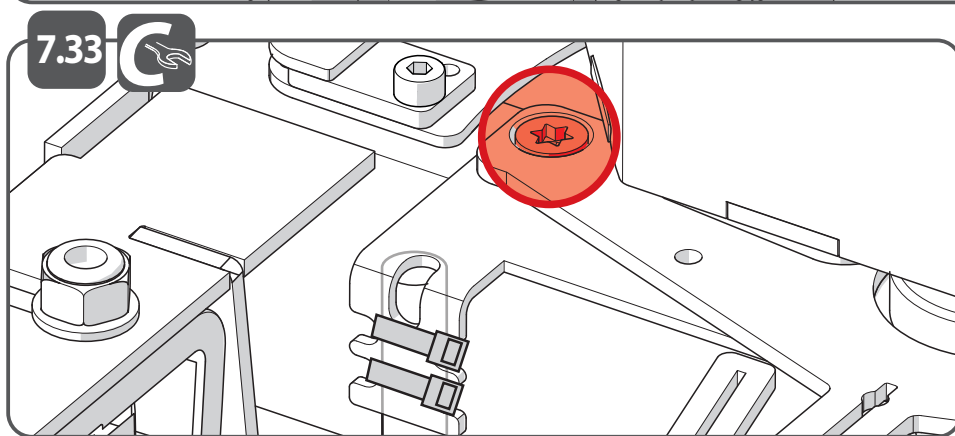
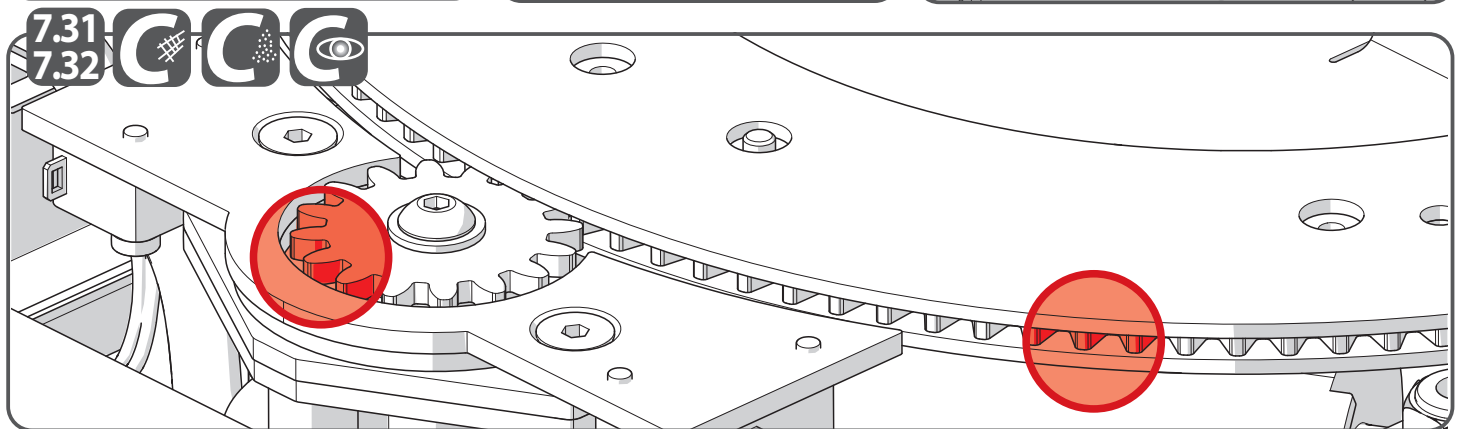
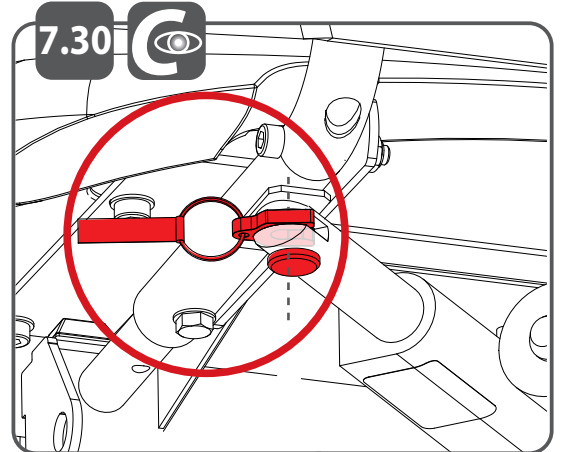
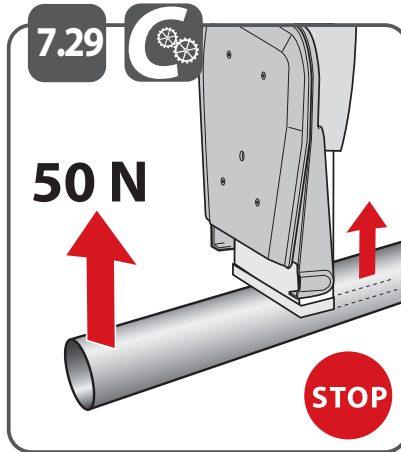
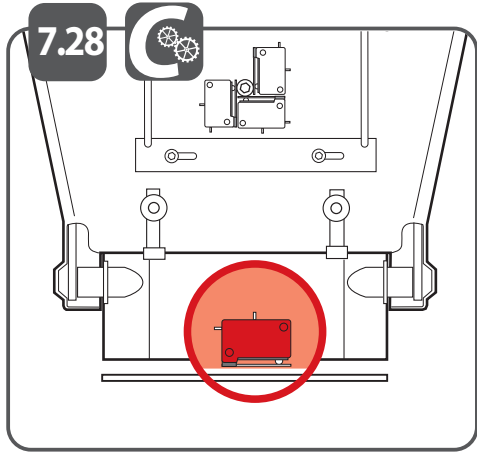
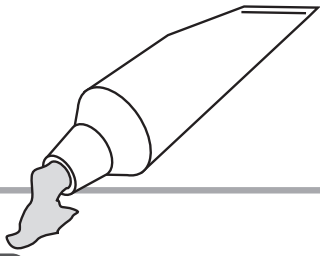

OPTIONS

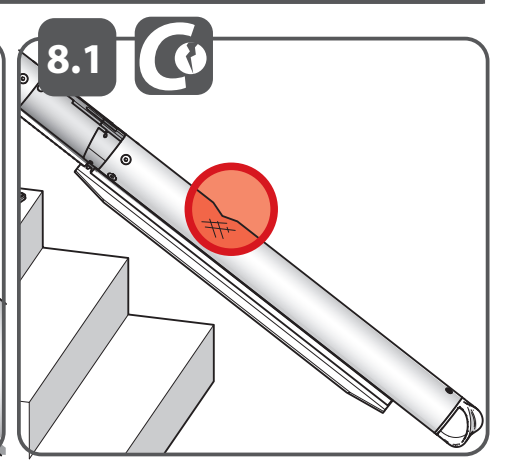
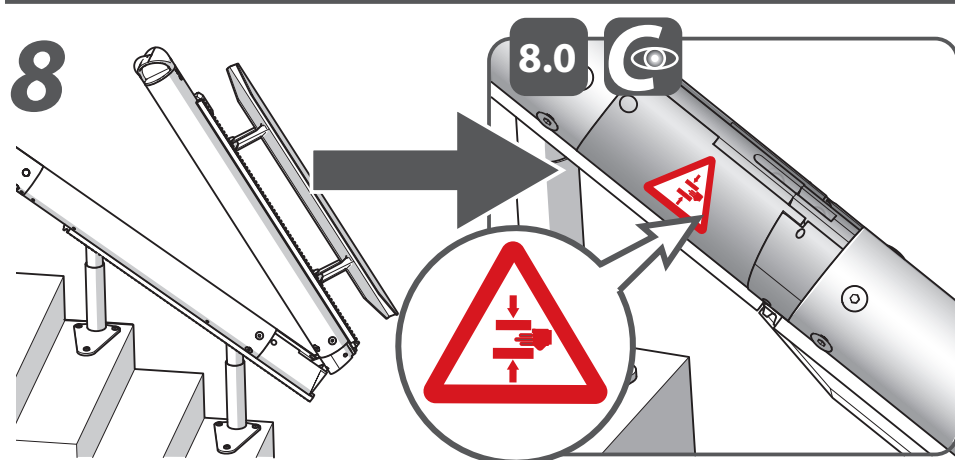

S

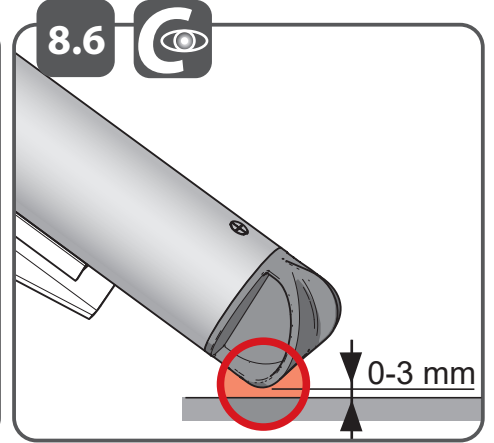
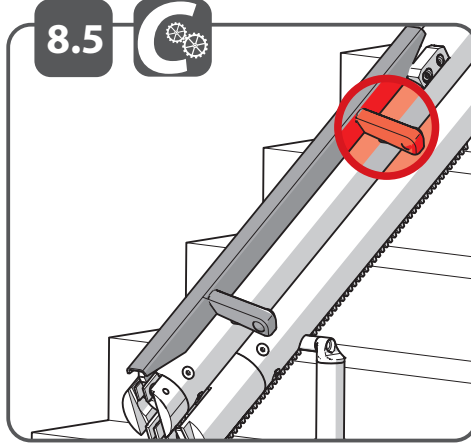
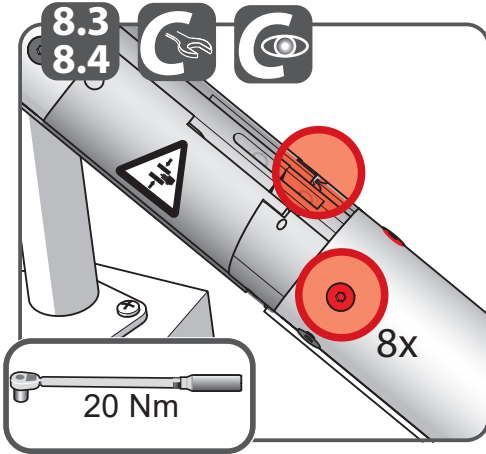
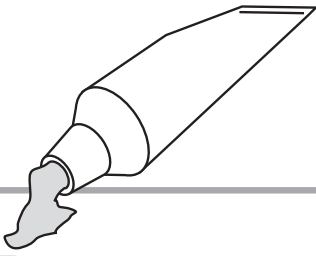

9

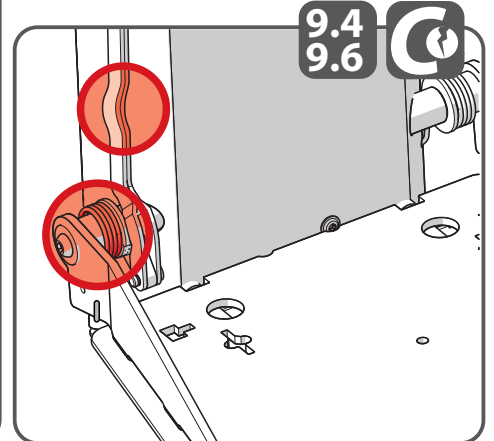
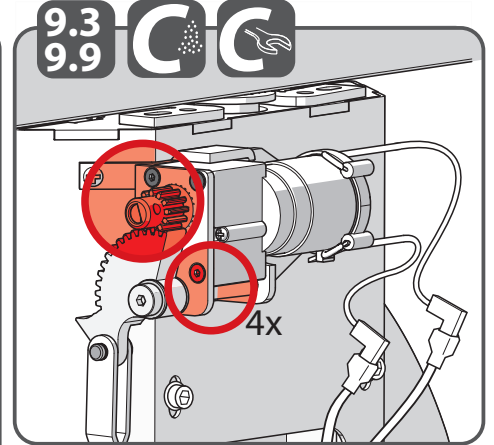
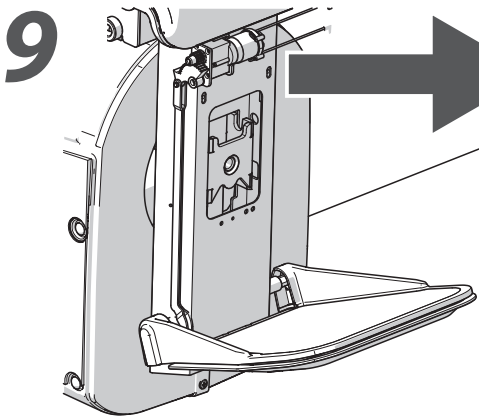

10

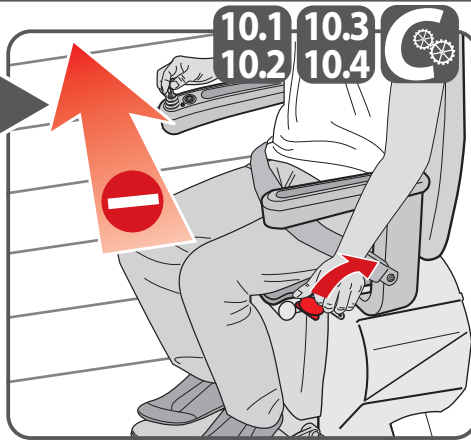

S

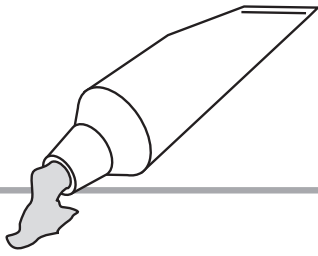

11

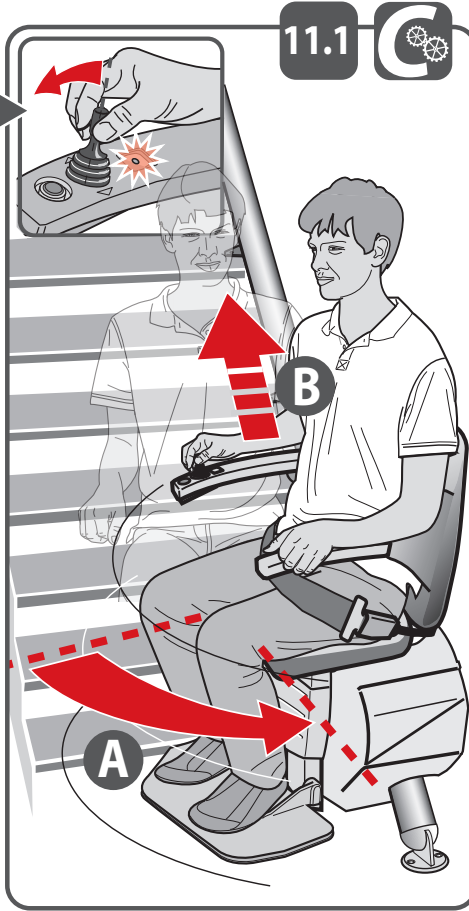

12

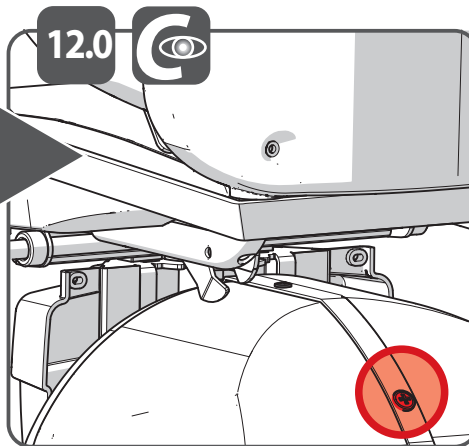
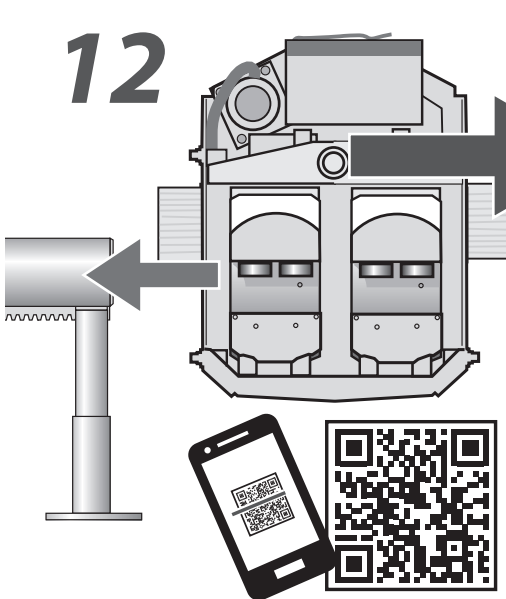

In case of the installation a new part on a existing lift always replace the part by a part with the same article number.



S

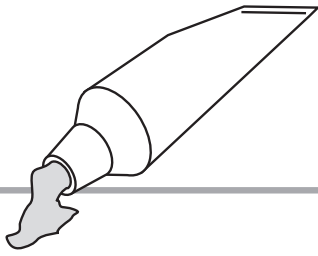

UK CERTIFICATE

For other languages than UK of this form please consult www.handicarepartners.com

CERTIFICATE FOR PERIODIC EXAMINATION VAN GOGH/REMBRANDT/VERMEER

Name:	
Address:	
Zipcode:	
City:	E-mail:
Telephonenumber:	Faxnumber:
Rail Type:	Van Gogh / Rembrandt / Vermeer
Type chair:	Classic / Basic / Plus / Select / Comfort / Elegance / Alliance
Options:	Autoswivel / Powered footrest / Turn&GO / VoiceConnect / ActiveSeat
Rail:	Standard / foldable
Projectnumber:	Additional details:
Unitnumber:	
Printnumber:	
Year:	

1. START



1.0	Meet customer and ask for his remarks about the lift		
1.1	Do a test ride under load and check if the lift is functioning okay		

2. STANDARD RAIL



2.0	Check the rail for damages		
2.1	Clean the rail for dirt		
2.2	Check the toothrack for damages/irregularities and check the weldings of the toothrack		
2.3	Grease the toothrack and slightly grease the Domex strip		
2.4	Check the Domex strip for damages and check the weldings of the Domex strip		
2.5	Check the fixation of the supports on the rail		
2.6	Check if the fixation of the supports are still tight		
2.7	Check the fixation of the supports on the stairs		
2.8	Check all fixations of the rail		
2.9	Check presence of all insex screws of the joint		
2.10	Check that the insex screws of the joints are correctly fixed , replace when loosened		
2.11	Check that all rail parts are aligned		
2.12	Check the presence of both final limit actuators		
2.13	Check the function of the chargestations/hinged rail station on corrosion and if they are fitted correctly		
2.14	Check that the wallfixations are still fixed correctly		
2.15	If present, check the optional mechanical end cam plates for damages. Replace if the unit has hit this plate.		

3. CHARGER



3.0	Check the function of the charger (orange/ green ledstatus)		
3.1	Check the wiring for damages		
3.2	Check that the plug is in the socket		
3.3	Check that the safety label is placed.		

4. REMOTES



4.0	Check remotes for damages		
4.1	Replace the batteries in the remotes (Penlight AAA)		
4.2	Check if the remotes are fitted correctly to the wall		
4.3	Check if the light in the remotes illuminates .		
4.4	Check the function of all remotes		

S

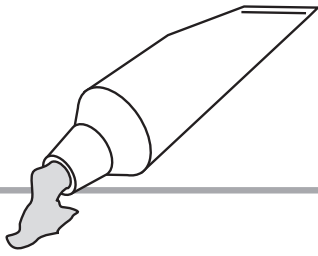

For examination of this section the chair, covers and the unit should to be taken of the rail

5. UNIT_mechanical		X	✓
5.0	Check the unit frame for damages		
5.1	Check batteriesupport for damages		
5.2	Check the fixation of the strap on the batteries		
5.3	Check the welding of the chairsupport		
5.4	Check if the circlip on the chairleveling motor is fitted correctly		
5.5	Grease the pinion and the toothrack for the chairleveling		
5.6	Check if the circlip/locking ring on the backside of the unit is fitted correctly on the axe (6 Nm)		
5.7	Check if the steelroller (bearings) run smoothly		
5.8	Clean the nylon rollers and Check for wear		
5.9	Check if the plastic roller run smoothly and grease with Molykote 4500		
5.10	Check the fixing of the rollers		
5.11	Check the carbonbrushes for damage, excessive wear and spring-back capability		
5.12	Clean the space at the pinions and roller (remove paint and dirt)		
5.13	Check pinions for wear and grease if necessary		
5.14	Check the mainaxle for oilleakage		
5.15	Check the gearing for oilleakage		
5.16	Check if the brakes loosen correctly		
5.17	Check the motorframes for damages		
5.18	Grease the motorframes above and under		
5.19	Check if the motorframes (curved surface) turn smoothly		
5.20	Check the boogiebolts above and underneath the motorframes of the unit for wear (min. 14 mm)		
5.21	Check fixing and torque of the boogiebolts above and underneath the motorframes		
5.22	Check on the Rembrandt if the fixation plate on the lower motor has been fixed		

For examination of this section the unit should be put back on the rail and then calibrated

6. UNIT_electrical		X	✓
6.0	Check batteries for damages and corrosion on the connections		
6.1	Check wiring battery-connections for damages		
6.2	Check fuseholder for corrosion		
6.3	Check the capacity of the batteries with a battery tester		
6.4	Check the wiring for damages		
6.5	Check if the wiring is fitted correctly		
6.6	Check the connector of the carbonbrushes and the final limit switch		
6.7	Check the function of all cover detectionswitches		
6.8	Check the fixation and function of the tilt switch		
6.9	Check the mass connection on the frame		
6.10	Check the function of the final limit switches in the unit		
6.11	Check the function of the calibration switch and the direction switch		
6.12	Check if the stairlift beeps when not on a chargestation		
6.13	Check that the chair support is fixed correctly		

S

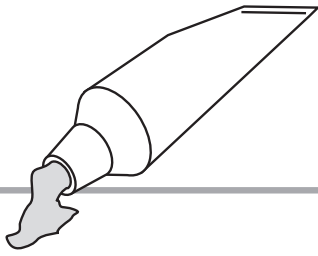

For examination of this section reinstall all removed parts of the lift

7. CHAIR		X	✓
7.1	Check the fixation of the chair		
7.2	Check that the wiring is fitted correctly		
7.3	Check the wiring for damages		
7.4	Check the presence of the CE sticker		
7.5	Check the chair for damages		
7.6	Check for too much noise		
7.7	Check the armrest and the armrest hinge for damages		
7.8	Check the function of the joystick and for damages		
7.9	Check the function of the keyswitch and the presence of the spare key		
7.10	Check the fixation of the safety belt bracket and function of the safety belt		
7.11	Check the mechanical lock and adjustment rings (tightened till seat frame) of the swivel mechanism		
7.12	Check presence and fixation of the bolts and safetyclip (1x) under the seat		
7.13	Check all welding of the chair frame pivot		
7.14	Check the fixation of the armrests of the Elegance-chair		
7.15	Check presence and fixation of the rubber caps under the seat		
7.16	Check the footrest for damages		
7.17	Check the fixation of the footrest		
7.18	Check the fixation of the Basic chair		
7.19	Check the welding on the swivelmechanism of the Basic/Plus chair.		
7.20	Check the function of the chair position switch under the seat		
7.21	Check the function of the final limit switches		
7.22	Check the functionality of the stop button		
7.23	Check the functionality of the armrest switches		
7.24	Check accuracy of the brake		
7.25	Check the function of all footrest detection switches		
7.26	Check the footrest detection is less than 50 N in 3 directions		
7.27	Check the cover detection is less than 100N in both directions		
7.28	Check the function of the chair support detection switch		
7.29	Check the chairsupport detection is less than 50 N in the up direction		
7.30	Check presence and fixation of the manual override of the autoswivel under the seat		
7.31	Clean the gearsegment		
7.32	Check the gearsegment and gearwheel for wear		
7.33	Check the fixation of all the bolts of the powered swivel		

S

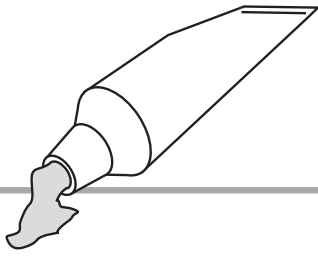

8. OPTIONS > FOLDABLE HINGE		X	✓
8.0	Check that the warning sticker for pitching is present		
8.1	Check the foldable rail for damages		
8.2	Check the foldable rail for retrofit (installations before januari 2006 with 3 x M6)		
8.3	Check the fixings on the foldable rail motor		
8.4	Check for tolerance of the foldable rail motor		
8.5	Check the function of the plastic cover over the foldable rail, if necessary adjust the hinge		
8.6	Check the tolerance between the foldable rail and the floor (0-3mm)		

9. OPTIONS > POWERED FOOTREST		X	✓
9.0	Check that the button of the powered footrest is functioning		
9.1	Check that the footrest (un)folds smoothly		
9.2	Check that the lighting (if connected) is illuminated if the footrest is unfolded and the lift on a charge station		
9.3	Check the gear and rack segment of the folding mechanism for wear		
9.4	Check the spring for damage		
9.5	Check the sound of the motor (replace when the noise is too much)		
9.6	Check the folding mechanism for damage		
9.7	Check that the footrest is not functioning if the emergency button is pressed or the keyswitch is off.		
9.8	Check that the safety is functioning (when the footrest is (un)folding, it must stop when blocked)		
9.9	Check that the bolts of the motorframes are still fixed		

10. OPTIONS > ACTIVE SEAT		X	✓
10.0	Check all functions of the ActiveSeat		
10.1	Check bistability of the control lever (unlock > lever stays up , seat up > lever goes back)		
10.2	Check that the seat is locking well (click sound)		
10.3	Check that the control lever is moving smoothly		
10.4	Check that the safety switches are functioning		
10.5	Check that there is no serious wear on locking mechanism		

11. OPTIONS > REMAINING		X	✓
11.0	Check the functions of the powered swivel		
11.1	Check the function of the Turn&Go		
11.2	Check the function of the VoiceConnect		

12. FINISH		X	✓
12.0	Check that all removed parts are reinstalled proper		
12.1	Make again a final test ride and check if the lift is still functioning okay		
12.2	Thank the customer for their time and mention to them that they can call the dealer if there are any problems		

The stairlift is safe / unsafe		Remarks
What repairs, renewals or alterations are required to enable the stairlift to continue to be used safely?		
State specified time limit for these repairs:		Date of examination:
Certified Handicare dealer:	Name/signature certified engineer:	Name/signature customer:

ATTACHMENTS

ANNEXE

ANEXO

ANHANG

ANNEXE

APPENDICE

BILAG

BIJLAGE

ZALACNIK

ANEXO

BILAGO

TILBEHØR

A

SPAREPARTS

8A

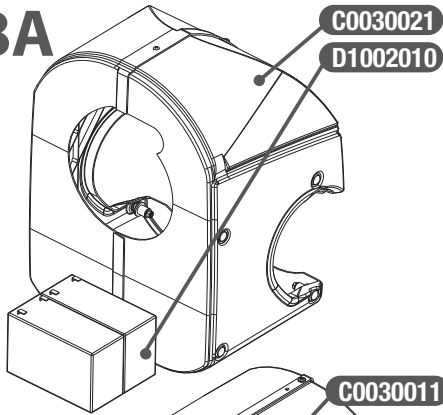

12A

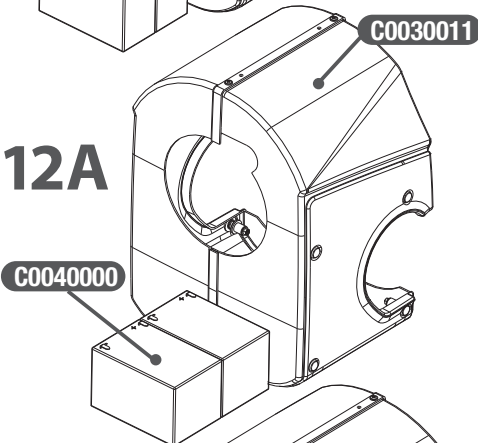

20A

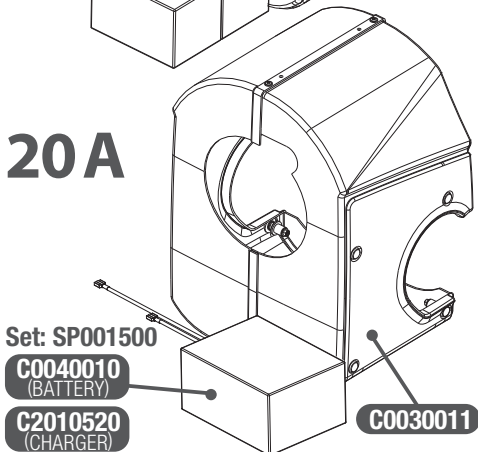

- E0005100
- E0005200
- E0006100
- C3020900
- C3020010

C1001413
(868 Mhz)



C1001513
(868 Mhz)

SP001000 REPEATER SET

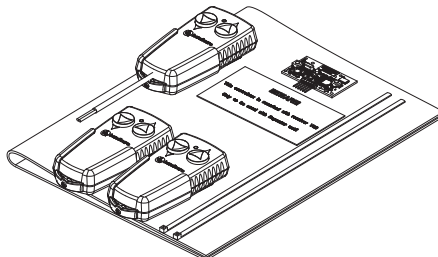

UNIT	868 Mhz
R250	C0020057

H0013183

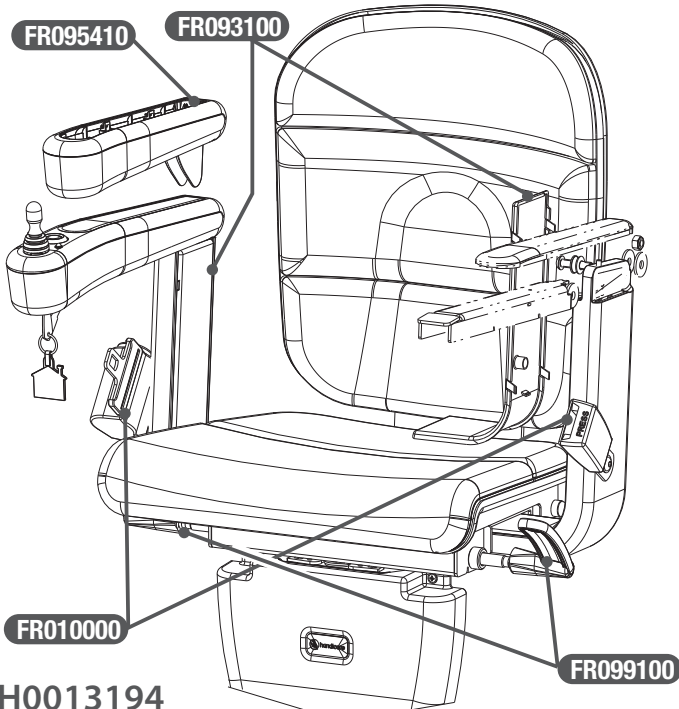

H0013194

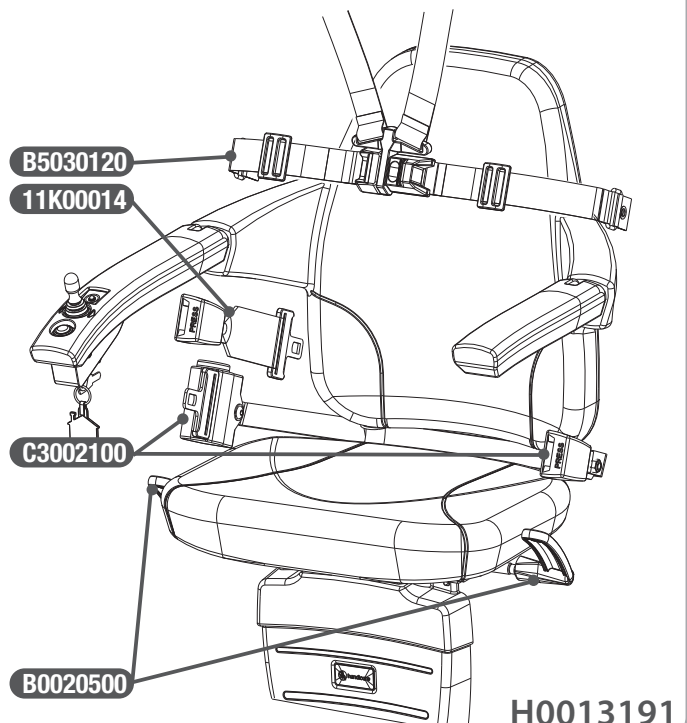

H0013191

B

FINAL LIMIT FAILURE TEST

AA24603_10_240521

USED TOOLS

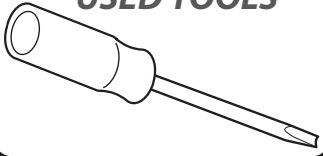

The lift must stop at the end of his normal track. If this is not the case the backup-safety must still stop the lift. For this it is essential the final limit switches in the unit are working correct.

[1] Ride the lift up, but not until the end of his ride. Press and hold the right final limit switch at the back of the unit. Check, by operating the joystick, if the lift does not move in any direction.
[2] Press and hold the left final limit switch. Check, by operating the joystick, if the lift does not move in any direction.

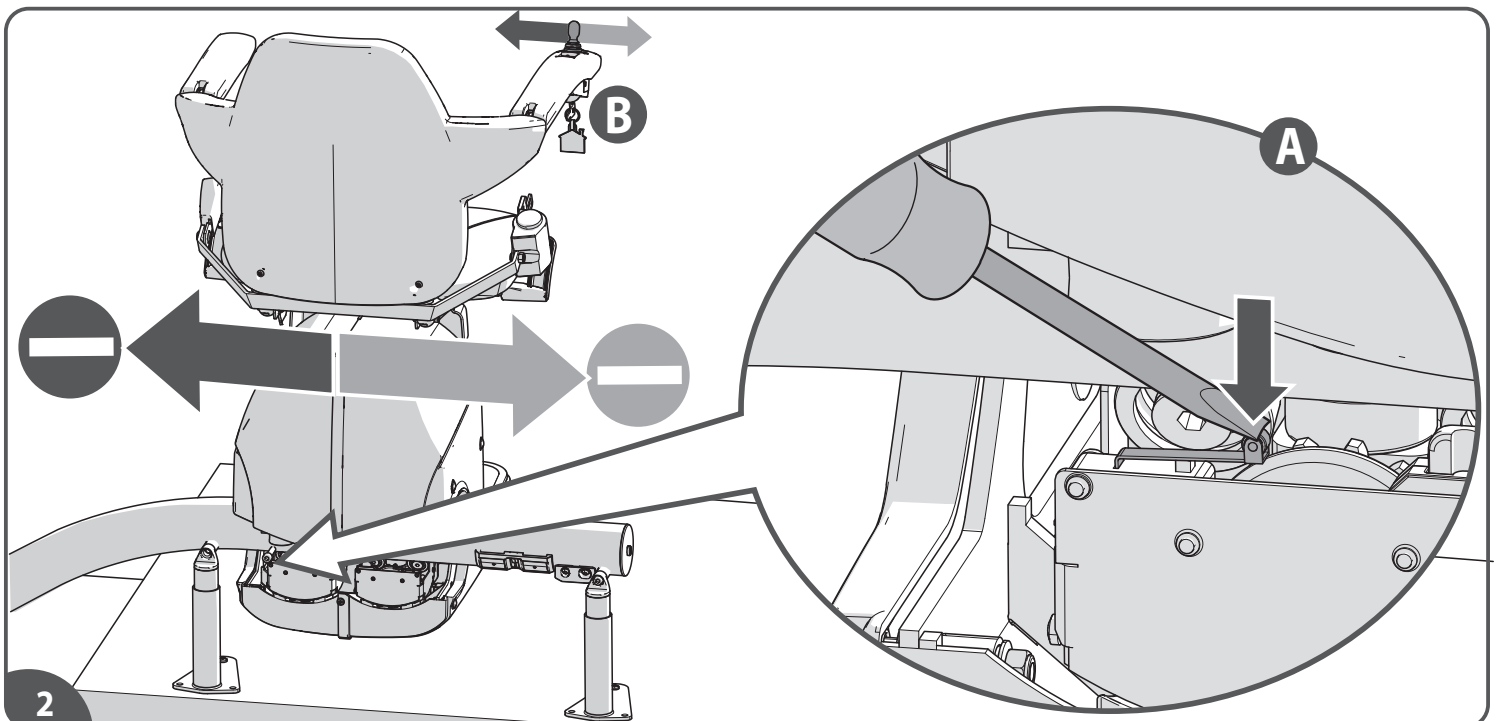
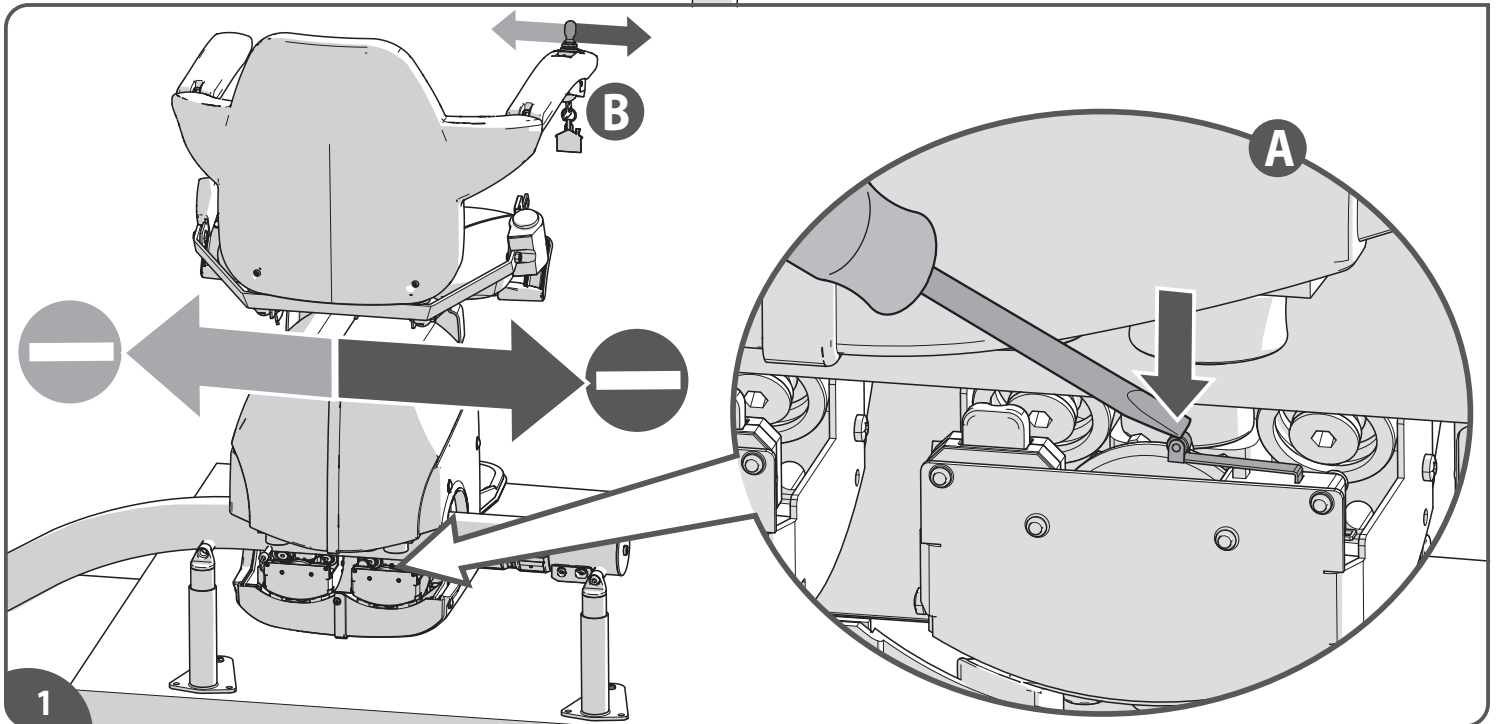

**Handicare Stairlifts B.V.**

Newtonstraat 35
1704 SB Heerhugowaard
The Netherlands
T +31 (0)72 576 88 88
traplift@handicare.com

Handicare Accessibility Ltd.

82 First Avenue,
Pensnett Estate Kingswinford,
West Midlands DY6 7FJ,
England T +44 (0)1384 408700
enquiries@handicare.co.uk

Handicare Monte-escaliers

4 Rue des Piverts
ZAC de l' Aunaie
91610 Ballancourt-sur-Essonne
France
T +33 (0)1 84 88 73 77
tps.fr@handicare.com

Handicare GmbH

Hausberger Straße 16
32457 Porta Westfalica
Deutschland
tel+49 (0) 571 97 33 98 -55
tps.de@handicare.com

Handicare Montascale

Via Chiaviche 17
46020 Pegognaga (MN)
Italy T +39 (0)376 143 3516
Montascale@handicare.com

Handicare USA

Inc. 10888 Metro Court
St. Louis, MO 63043
United States of America
Toll Free: 1.888.637.8155
Local: 314.692.9135
sales.us@handicare.com

Savaria Canada

2 Walker Drive Brampton,
ON L6T 5E1 Canada
T 1.905.791.5555
T 1.855.728.2742
info@savaria.com

[www.handicare .com](http://www.handicare.com)

SERVICE MANUAL

SERVICEHANDLEIDING
MANUAL DE SERVICE
KUNDENDIENSTANLEITUNG
MANUALE PER SERVIZIO
MANUAL DE SERVICIO
SERVIS RAPORU
SERVIÇO MANUAL
VEDLIKEHOLD SHANDBOKEN
UNDERHALLSMANUAL
座椅电梯维护



11P00342_S_291123