



**FUTURE**  
MOBILITY HEALTHCARE

*Innovative Seating and Mobility Solutions*



**OWNERS MANUAL**

# 1 CONTACT INFORMATION

## **FUTURE MOBILITY HEALTHCARE INC. APPRECIATES YOUR FEEDBACK**

**Supplier:** Please give this manual to the user of the wheelchair.

**User:** Please read this entire manual before using this wheelchair.

Thank you for choosing Future Mobility Healthcare Inc.

If you have any questions please do not hesitate to write or call us at the address and telephone number below:

**Future Mobility Healthcare Inc.**

Customer Service Canada

6750 Professional Court

Mississauga ON L4V 1X6

Phone: (888) 737-4011 or (905) 671-1661

Fax: (905) 671-3377

e-mail: [customerservice@futuremobility.ca](mailto:customerservice@futuremobility.ca)

[www.futuremobility.ca](http://www.futuremobility.ca)

## 2 TABLE OF CONTENTS

### TABLE OF CONTENTS

<b>1</b>	<b>CONTACT INFORMATION .....</b>	<b>2</b>
<b>2</b>	<b>TABLE OF CONTENTS .....</b>	<b>3</b>
<b>3</b>	<b>PARTS OF THE WHEELCHAIR.....</b>	<b>5</b>
<b>4</b>	<b>NOTICE – READ BEFORE USE .....</b>	<b>6</b>
	CHOOSE THE CORRECT CHAIR AND OPTIONS .....	6
	REVIEW THIS MANUAL OFTEN .....	6
	WARNING .....	6
<b>5</b>	<b>LABEL LOCATIONS .....</b>	<b>7</b>
<b>6</b>	<b>GENERAL WARNINGS .....</b>	<b>8</b>
	USER WEIGHT LIMIT .....	9
	WEIGHT TRAINING .....	9
	GETTING TO KNOW YOUR CHAIR .....	9
	TO REDUCE THE RISK .....	9
	SAFETY CHECKLIST .....	9
	CHANGES AND ADJUSTMENTS .....	10
	GROUND TERRAIN .....	10
	CENTER OF GRAVITY .....	10
	WHEELIES .....	10
	ROLLING BACKWARDS .....	11
	REACHING OR LEANING .....	11
	RAMPS AND SLOPES .....	11
	TRANSFERS .....	12
<b>7</b>	<b>ATTENDANT WARNINGS .....</b>	<b>13</b>

	DESCENDING A CURB .....	13
	CLIMBING A CURB .....	13
	DESCENDING STAIRS .....	13
<b>8</b>	<b>COMPONENT WARNINGS .....</b>	<b>14</b>
	ANTI-TIP WHEELS .....	14
	ARMRESTS .....	14
	BACK CANES .....	14
	FASTENERS .....	14
	FOOTRESTS .....	14
	POSITIONING BELTS .....	15
	QUICK-RELEASE AXLES .....	15
	REAR WHEEL AXLES .....	15
	REAR WHEEL LOCKS .....	16
<b>9</b>	<b>WHEELCHAIR SET-UP AND ADJUSTMENTS.....</b>	<b>17</b>
	HEIGHT ADJUSTABLE FLIP-BACK ARM .....	17
	CENTER PIVOT SWINGAWAY FOOTREST .....	19
	DUAL SWINGAWAY FOOTREST .....	20
	DUAL PUSH SWINGAWAY FOOTREST .....	21
	DUAL ELEVATING LEGREST AND HANGER .....	22
	CASTER AND FORK ASSEMBLY .....	23
	REAR WHEEL AXLE (QUICK RELEASE) .....	25
	REAR WHEEL AXLE (FIXED BOLT) .....	26
	REAR WHEEL AXLE POSITION PLACEMENT.....	ERROR! BOOKMARK NOT DEFINED.
	FRONT SEAT TO FLOOR SET-UP CHART .....	27
	REAR WHEEL MOUNT POSITION .....	30
	FOLDING AND UNFOLDING THR WHEELCHAIR .....	31
	SEAT SLING .....	32
	REAR ANTI-TIPS .....	33

BACKREST .....	35
BACK UPHOLSTERY .....	37
WHEEL LOCKS .....	38
CUSHION INSTALLATION .....	38
TIE-DOWNS .....	39
<b>10 TROUBLE SHOOTING .....</b>	<b>40</b>
<b>11 MAINTENANCE .....</b>	<b>41</b>
SAFETY INSPECTION CHECKLIST .....	41
GENERAL MAINTENANCE .....	43
SERVICE AND REPAIR .....	43
CLEANING YOUR CHAIR .....	43
<b>12 WARRANTY .....</b>	<b>45</b>
LIFETIME .....	45
FOR TWO (2) YEARS .....	45
FOR (90) DAYS .....	45
LIMITATIONS .....	45
WARRANTY PROCEDURES .....	46

### 3 PARTS OF THE WHEELCHAIR

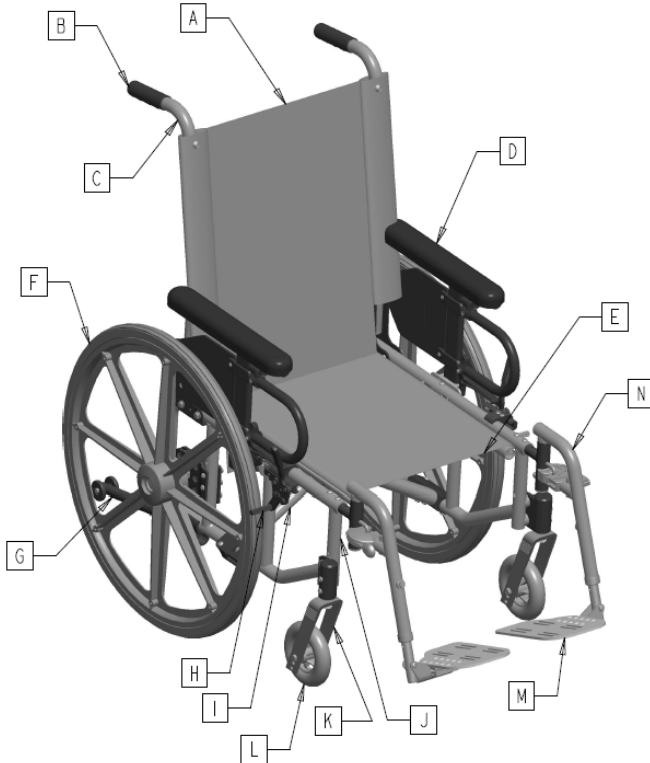

- A. BACK UPHOLSTERY
- B. BACK POST GRIP
- C. BACK CANES
- D. T-STYLE ARMREST
- E. SEAT SLING
- F. REAR WHEEL
- G. ANTI-TIP
- H. WHEEL LOCK
- I. CROSS BRACE
- J. SIDE FRAME
- K. CASTER FORK
- L. CASTER WHEEL
- M. FOOTREST
- N. SWINGAWAY LEGREST

## **4 NOTICE – READ BEFORE USE**

### **CHOOSE THE CORRECT CHAIR AND OPTIONS**

Future Mobility Healthcare Inc. provides a choice of many wheelchair styles to meet the requirements of the wheelchair user. However, the final selection of the wheelchair and its options rests solely with you and your health care advisor. Choosing the best chair will depend on such things as:

1. The level of your disability, strength, balance and coordination.
2. The places and terrain that you are likely to use your chair.
3. The need for options for your safety and comfort (such as anti-tip tubes, positioning belts, or special seating systems).

### **REVIEW THIS MANUAL OFTEN**

Before using this chair you, and each person who may assist you, should read this entire manual and make sure to follow all instructions. Review the warnings often.

### **WARNING**

The term “**WARNING**” are hazards or unsafe practices that may cause **severe injury or death** to you or to other persons.

## 5 LABEL LOCATIONS

### INSIDE RAIL

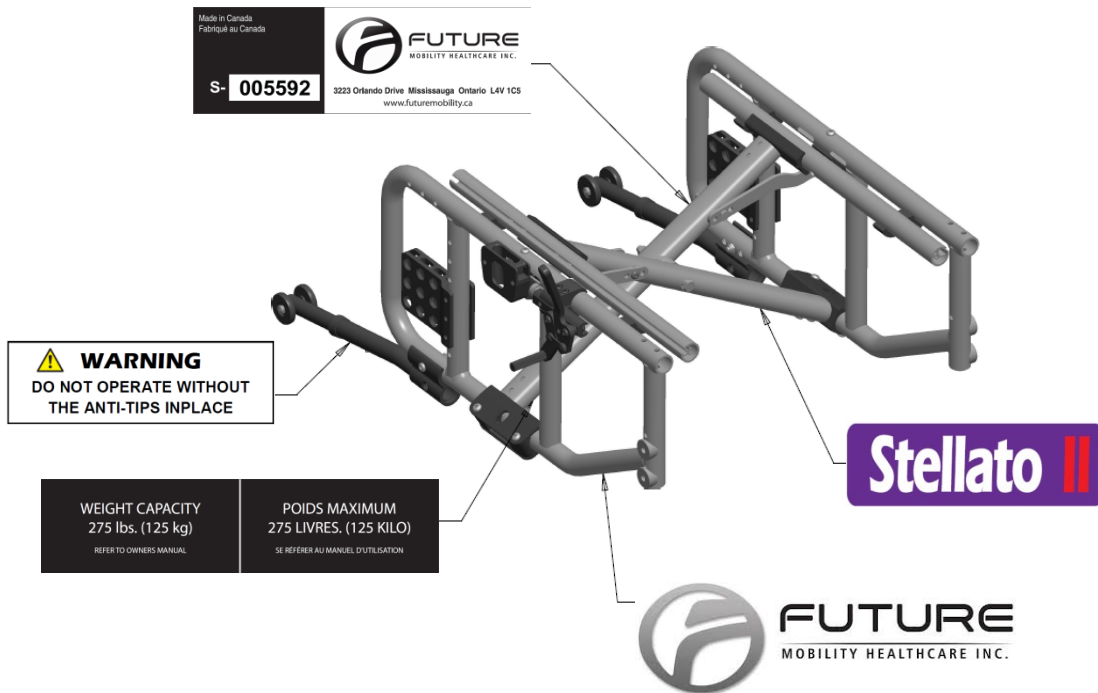

# OVER RAIL

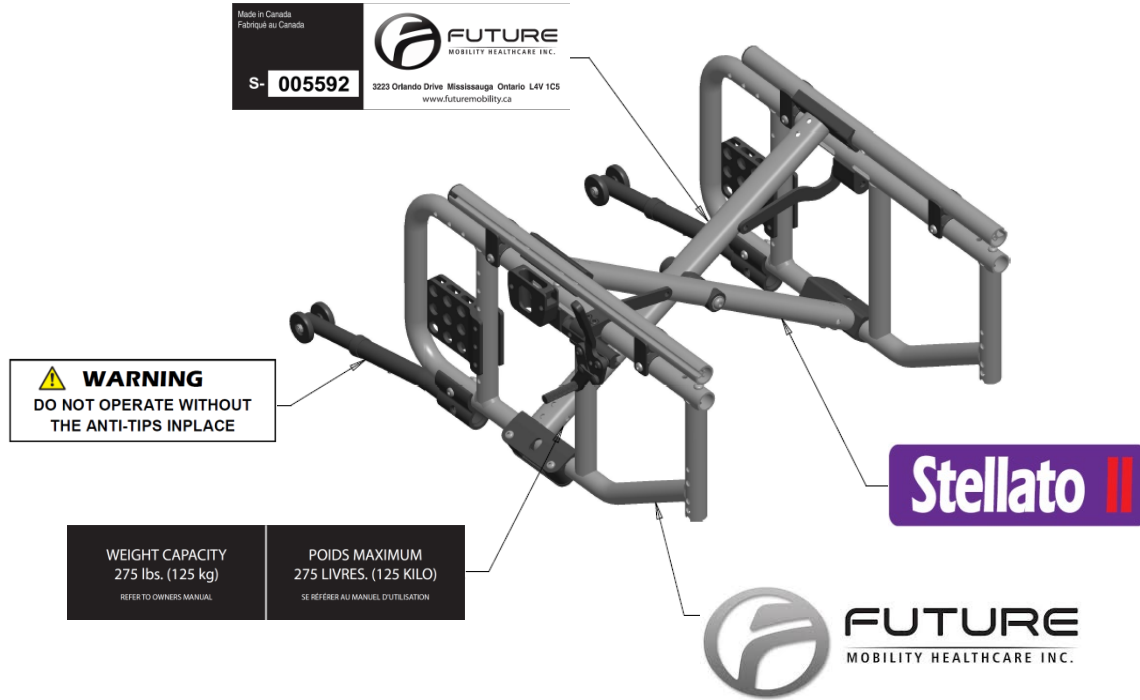



## 6 GENERAL WARNINGS

### USER WEIGHT LIMIT



NEVER exceed the weight limit of 275 pounds for a combined weight of rider and items carried. If you do exceed the limit, damage to your chair, tip-over or loss of control may occur and cause severe injury to the rider or others.

### WEIGHT TRAINING



NEVER use this chair for weight training if total weight (rider plus equipment) exceeds 275 pounds. If you do exceed the limit, damage to your chair, tip-over or loss of control may occur and cause severe injury to the rider or others.

### GETTING TO KNOW YOUR CHAIR



Every wheelchair is different. Take the time to learn the feel of this chair before you begin riding. Start slowly, with easy, smooth strokes. If you are used to a different chair, you may use too much force and tip over. If you use too much force, damage to your chair, a fall, tip over or loss of control may occur and cause severe injury to the rider or others.

## TO REDUCE THE RISK



1. BEFORE riding, you should be trained in the safe use of this chair by your health care advisor.
2. Practice bending, reaching and transfers until you know the limit of your ability. Have someone help you until you know what can cause a fall or tip-over and how to avoid doing so.
3. Be aware that you must develop your own methods for safe use best suited to your level of function and ability.
4. NEVER try a new maneuver on your own until you are sure you can do it safely.
5. Get to know the areas where you plan to use your chair. Look for hazards and learn how to avoid them.
6. Use anti-tip tubes unless you are a skilled rider of this chair and are sure you are not at risk to tip over.

## SAFETY CHECKLIST



Before each use of your chair:

1. Make sure the chair rolls easily and that all parts work smoothly. Check for noise, vibration, or a change in ease of use. (They may indicate low tire pressure, loose fasteners, or damage to your chair).
2. Repair any problem. Your authorized supplier can help you find and correct the problem.

3. Check to see that both quick-release rear axles are locked. When locked, the axle button will “pop out” fully.

## CHANGES AND ADJUSTMENTS



### WARNING

1. If you modify or adjust this chair, it may increase the risk of a tip-over UNLESS you make other changes as well.
  2. **Consult your authorized supplier BEFORE you modify or adjust your chair, or contact Future Mobility Healthcare.**
  3. We recommend that you use anti-tip tubes until you adapt to the change, and are sure you are not at risk to tip over.
  4. Unauthorized modifications or use of parts not supplied or approved by Future Mobility Healthcare may change the chair structure.
- A. This will void the warranty and may cause a safety hazard.

## GROUND TERRAIN



### WARNING

1. Your chair is designed for use on firm, even surfaces such as concrete, asphalt and indoor floors and carpeting.
2. Do not operate your chair in sand, loose soil or over rough terrain. This may damage wheels or axles, or loosen fasteners of your chair.

## CENTER OF GRAVITY



### WARNING

**The point where this chair will tip forward, back, or to the side depends on its center of gravity and stability.**

**How your chair is set up, the options you select and the changes you make may affect the risk of a fall or tip-over.**

1. The Most Important Adjustments Are:
  - a. The position of the rear wheels. The more you move the rear wheels forward, the more likely your chair will tip over backward.
  - b. The position of the carriage.
2. The Center Of Gravity Is Also Affected By:
  - a. A change in the set-up of your chair, including:
    - i. The seat height and seat angle.
    - ii. Backrest angle.
  - b. A change in your body position, posture or weight distribution.
  - c. Riding your chair on a ramp or slope.
  - d. The use of a back pack or other options, and the amount of added weight.

## WHEELIES



### WARNING

Because of the ability to adjust the center of gravity and changes in center of gravity that will result from operating the tilt in space feature of this chair, as a user, do not perform wheelies in this wheelchair. Doing a “wheelie” means: balancing on the rear wheels of your chair, while the front casters are in the air. It is dangerous to do a “wheelie” as a fall or tip-over may occur.

## ROLLING BACKWARDS



### WARNING

Use extra care when you move your chair backward.

Your chair is most stable when you propel yourself forward.

You may lose control or tip over if one of the rear wheels hits an object and stops rolling.

1. Propel your chair slowly and smoothly.
2. If your chair has anti-tip tubes, make sure to lock them in place.
3. Stop often and check to be sure your path is clear.

## REACHING OR LEANING



### WARNING

If you reach or lean it will affect the center of balance of your chair. This may cause you to fall or tip over. When in doubt, ask for help or use a device to extend your reach.

1. NEVER reach or lean if you must shift your weight sideways or rise up off the seat.
2. NEVER reach or lean if you must move forward in your seat to do so. Always keep your buttocks in contact with the backrest.
3. NEVER reach with both hands (you may not be able to catch yourself to prevent a fall if the chair tips).
4. NEVER reach or lean to the rear unless your chair has anti-tip tubes locked in place.
5. DO NOT reach or lean over the top of the seat back. This may damage one or both backrest tubes and cause you to fall.
6. If You Must Reach Or Lean:

- a. Do not lock the rear wheels. This creates a tip point and makes a fall or tip-over more likely.
- b. Do not put pressure on the footrests.
- c. Move your chair as close as you can to the object you wish to reach.

## RAMPS AND SLOPES



### WARNING

Riding on a slope, which includes a ramp or side hill, will change the center of balance of your chair. Your chair is less stable when it is at an angle. Anti-tip tubes may not prevent a fall or tip-over.

1. Do not use your chair on a slope steeper than 10%.
2. Always go as straight up and as straight down as you can. (Do not “cut the corner” on a slope or ramp.)
3. Do not turn or change direction on a slope.
4. Always stay in the CENTER of the ramp. Make sure ramp is wide enough that you are not at risk that a wheel may fall over the edge.
5. Do not stop on a steep slope. If you stop, you may lose control of your chair.
6. NEVER use rear wheel locks to try to slow or stop your chair. This is likely to cause your chair to veer out of control.
7. Beware Of:
  - a. Wet or slippery surfaces.
  - b. A change in grade on a slope (or a lip, bump or depression).
  - c. A drop-off at the bottom of a slope. A drop-off of as small as 3/4 inch can stop a front caster and cause the chair to tip forward.

## TRANSFERS



### **WARNING**

**It is dangerous to transfer on your own. It requires good balance and agility. Be aware that there is a point during every transfer when the wheelchair seat is not below you. To Avoid A Fall:**

1. Work with your health care advisor to learn safe methods.
  - a. Learn how to position your body and how to support yourself during a transfer.
  - b. Have someone help you until you know how to do a safe transfer on your own.
2. Lock the rear wheels before you transfer. This keeps the rear wheels from rolling.
3. Make sure to keep pneumatic tires properly inflated. Low tire pressure may allow the rear wheel locks to slip.
4. Move your chair as close as you can to the seat you are transferring to. If possible, use a transfer board.
5. Rotate the front casters until they are as far forward as possible.
6. If you can, remove or swing footrests out of the way.
  - a. Make sure your feet do not catch in the space between the footrests.
  - b. Avoid putting weight on the footrests as this may cause the chair to tip.

## 7 ATTENDANT WARNINGS

### DESCENDING A CURB



#### **WARNING**

Follow these steps to help a rider descend a curb or single step going **BACKWARD**:

1. Stay at the rear of the chair.
2. Several feet before you reach the edge of the curb or step, turn the chair around and pull it backward.
3. While looking over your shoulder, carefully step back until you are off the curb or stair and standing on the lower level.
4. Pull the chair toward you until the rear wheels reach the edge of the curb or step. Then allow the rear wheels to slowly roll down onto the lower level.
5. When the rear wheels are safely on the lower level, tilt the chair back to its balance point. This will lift the front casters off the curb or step.
6. Keep the chair in balance and take small steps backward.
7. Turn the chair around and gently lower front casters to the ground

### CLIMBING A CURB



#### **WARNING**

Follow these steps to help the rider climb a curb or single step going **FORWARD**:

1. Stay behind the chair.

2. Face the curb and tilt the chair up on the rear wheels so that the front casters clear the curb or step.
3. Move forward, placing the front casters on the upper level as soon as you are sure they are past the edge.
4. Continue forward until the rear wheels contact the face of the curb or step. Lift and roll the rear wheels to the upper level.

### DESCENDING STAIRS



#### **WARNING**

1. Use at least two attendants to move a chair and rider down stairs.
2. Move the chair and rider **FORWARD** down the stairs.
3. The person at the rear is in control. He or she tilts the chair to the balance point of the rear wheels and rolls it to the edge of the top step.
4. A second attendant stands on the third step from the top and grasps the hanger receiver or front most part of the seat rail. He or she lowers the chair one step at a time by letting the rear wheels roll over the stair edge.
5. The attendants move to the next stair down. Repeat for each stair, until you reach the landing.

## 8 COMPONENT WARNINGS

### ANTI-TIP WHEELS



Anti-tip wheels can help keep your chair from tipping over backward in most normal conditions.

1. Future Mobility Healthcare Recommends Use Of Anti-Tip Tubes:
  - a. UNLESS you are a skilled rider of this chair and are sure you are not at risk to tip over.
  - b. Each time you modify or adjust your chair. The change may make it easier to tip backward. Use anti-tip tubes until you adapt to the change, and are sure you are not at risk to tip over.
2. When locked in place (in the “down” position) anti-tip tubes should be BETWEEN 1 1/2 and 2 inches off the ground.
  - a. If set too HIGH, they may not prevent a tip-over.
  - b. If set too LOW, they may “hang up” on obstacles you can expect in normal use. If this occurs, you may fall or your chair may tip over.
3. Keep Anti-Tip Tubes Locked In Place UNLESS:
  - a. You have an attendant, or
  - b. You have to climb or descend a curb, or overcome an obstacle, and can safely do so without them. At these times, make sure anti-tip tubes are up, out of the way.

### ARMRESTS



Armrests will not bear the weight of this chair.

1. NEVER lift this chair by its armrests. They may come loose or break.
2. Lift this chair only by non-detachable parts of the main frame.

### BACK CANES



Always keep fingers away from the locking mechanism located at the bottom of the back canes when folding the back down or pulling it back up.

### FASTENERS



Many of the screws, bolts and nuts on this chair are special high-strength fasteners. Use of improper fasteners may cause your chair to fail.

1. ONLY use fasteners provided by an authorized supplier (or ones of the same type and strength, as indicated by the markings on the heads).
2. Over- or under-tightened fasteners may fail or cause damage to chair parts.
3. If bolts or screws become loose, tighten them as soon as you can.

### FOOTRESTS



Footrests will not bear the weight of this chair

1. At the lowest point, footrests should be AT LEAST 2 INCHES off the ground. If set too LOW, they may “hang up” on obstacles you can expect to find in normal use. This may cause the chair to stop suddenly and tip forward.
2. To Avoid A Trip Or Fall When You Transfer:
  - a. Make sure your feet do not “hang up” or get caught in the space between the footrests.
  - b. Avoid putting weight on the footrests, as the chair may tip forward.
3. NEVER lift this chair by the footrests. Footrests detach and will not bear the weight of this chair. Lift this chair only by non-detachable parts of the main frame.

## POSITIONING BELTS



### WARNING

Use positioning belts **ONLY** to help support the rider’s posture. Improper use of these belts may cause severe injury to or death of the rider.

1. Make sure the rider cannot slide down in the wheelchair seat.
2. If this occurs, the rider may suffer chest compression or suffocate due to pressure from the belts.
3. The belts must be snug, but must not be so tight that they interfere with breathing. You should be able to slide your open hand, flat, between the belt and the rider.
4. A pelvic wedge or a similar device can help keep the rider from sliding down in the seat. Consult with the rider’s doctor, nurse or therapist to find out if the rider needs such a device.
5. Use positioning belts only with a rider who can cooperate.
6. Make sure the rider can easily remove the belts in an emergency.

7. NEVER Use Positioning Belts:
  - a. As a patient restraint. A restraint requires a doctor’s order.
  - b. On a rider who is comatose or agitated.
  - c. As a motor vehicle restraint. In an accident or sudden stop the rider may be thrown from the chair. Wheelchair seat belts will not prevent this, and further injury may result from the belts or straps.

## QUICK-RELEASE AXLES



### WARNING

1. Do not use this chair UNLESS you are sure that both quick-release rear axles are locked. An unlocked axle may come off during use and cause a fall.
2. An axle is not locked until the quick-release button pops out fully. An unlocked axle may come off during use, resulting in a fall, tip-over or loss of control and cause severe injury to the rider or others.

## REAR WHEEL AXLES



### WARNING

A change in set-up of the rear wheels will affect the center of balance of your chair.

1. The farther you move the rear axles FORWARD, the more likely it is that your chair will tip over backward.
2. Consult your doctor, nurse or therapist to find the best rear axle set-up for your chair. Do not change the set-up UNLESS you are sure you are not at risk to tip over.

3. Adjust the rear wheel locks after you make any change to the rear axles.
  - a. If you fail to do so, the locks may not work.
  - b. Make sure wheel locks are embedded in tires at least 1/8 inch when locked.

## **REAR WHEEL LOCKS**



### **WARNING**

**Rear wheel locks are NOT designed to slow or stop a moving wheelchair. Use them only to keep the rear wheels from rolling when your chair is at a complete stop.**

1. NEVER use rear wheel locks to try to slow or stop your chair when it is moving. Doing so may cause you to veer out of control.
2. To keep the rear wheels from rolling, always set both rear wheel locks when you transfer to or from your chair.
3. Low pressure in a rear tire may cause the wheel lock on that side to slip and may allow the wheel to turn when you do not expect it.
4. Make sure wheel locks are embed in tires at least 1/8 inch when locked. If you fail to do so, the locks may not work.



## 9 WHEELCHAIR SET-UP AND ADJUSTMENTS

### HEIGHT ADJUSTABLE FLIP-BACK ARM

1

#### 1. Engaging and Disengaging Flip-back Arm

- To disengage, press and hold the release lever (C) while pulling up on the arm body (A).
- Flip the armrest back; it remains attached to the rear pivot mount (E).
- To rearrange armrest; move the armrest down into place.
- Press down until the release lever (C) locks into the receiver (D).

#### 2. Height Adjustment

- Pull the release knob (B) to disengage the ball pin.
- Slide top armrest pad up or down to desired height and 'click' into position.
- Release the release knob (B) to lock the armrest.
- Push arm pad to check that it is locked firmly into place.

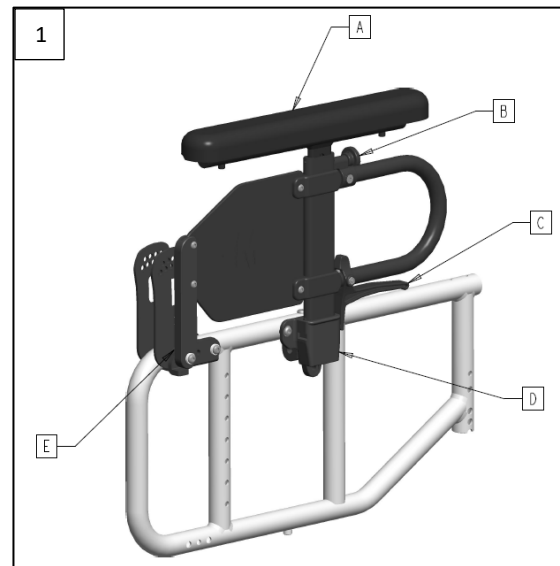

## PIN STYLE SWINGAWAY FOOTREST

2

### 1. Installation

- Insert the swingaway hanger (A) onto the side frame.
- Position the bracket of the swingaway footrest (C) onto the pin of hanger (A) with the swingaway footrest facing out from the wheelchair.
- Swing the footrest inwards such that the swingaway latch (B) 'clicks' into place onto the bracket.

### 2. Removal

- To remove the footrest, pull outward onto the handle latch (B) releasing the mechanism from the Pin and swing the footrest outwards.
- Pull up on the footrest to remove from wheelchair.

### 3. Height Adjustment

- Remove bolt (D) which holds the extension tube in place.
- Slide the footrest extension tube up or down to the desired height. Note a minimum of 2" should be kept between the footplate (E) and the floor.
- Re-install and tighten the bolt (D) in place.

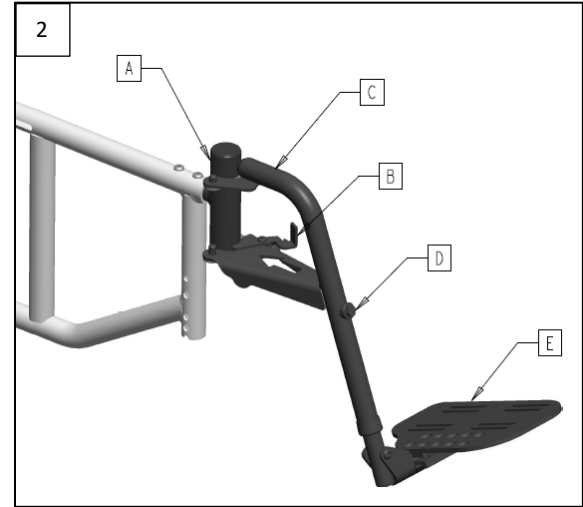

## CENTER PIVOT SWINGAWAY FOOTREST

3

### 4. Installation

- Insert the swingaway hanger (A) onto the side frame.
- Position the center pivot of the swingaway footrest (C) onto the hanger (A) with the swingaway footrest facing out from the wheelchair.
- Swing the footrest inwards such that the swingaway latch (B) 'clicks' into place onto the U-bolt.

### 5. Removal

- To remove the footrest, pull outward onto the handle latch (B) releasing the mechanism from the U-bolt and swing the footrest outwards.
- Pull up on the footrest to remove from wheelchair.

### 6. Height Adjustment

- Remove bolt (D) which holds the extension tube in place.
- Slide the footrest extension tube up or down to the desired height. Note a minimum of 2" should be kept between the footplate (E) and the floor.
- Re-install and tighten the bolt (D) in place.

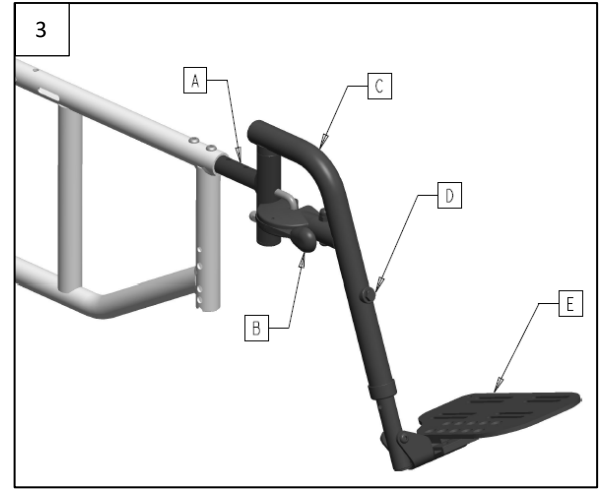

## LOCK BACK SWINGAWAY FOOTREST

4

### 1. Installation

- Insert the swingaway hanger (A) onto the side frame.
- Position the center pivot of the swingaway footrest (C) onto the hanger (A) with the swingaway footrest facing out from the wheelchair.
- Swing the footrest inwards such that the swingaway latch (B) 'clicks' into place onto the hanger block.

### 2. Removal

- To remove the footrest, pull up onto the handle latch (B) releasing the mechanism from the hanger and swing the footrest outwards or inwards.
- Pull up on the footrest to remove from wheelchair.

### 3. Height Adjustment

- Remove bolt (D) which holds the extension tube in place.
- Slide the footrest extension tube up or down to the desired height. Note a minimum of 2" should be kept between the footplate (E) and the floor.
- Re-install and tighten the bolt (D) in place.

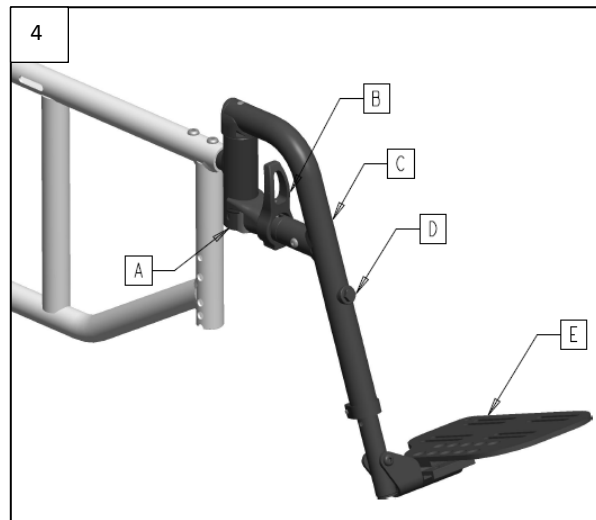

## UMPUTEE SWINGAWAY FOOTREST

4

### 1. Installation

- Insert the swingaway hanger (A) onto the side frame.
- Position the center pivot of the amputee swingaway (C) onto the hanger (B) with the swingaway amputee facing out from the wheelchair.
- Swing the footrest inwards such that the swingaway latch (B) 'clicks' into place onto the U-bolt.

### 2. Removal

- To remove the footrest, pull outward onto the handle latch (B) releasing the mechanism from the U-bolt and swing the footrest outwards.
- Pull up on the amputee swingaway to remove from wheelchair.

### 3. Height Adjustment

- Remove bolt which holds the extension tube (D) in place.
- Slide the amputee extension tube up or down to the desired height.
- Re-install and tighten the bolt in place.

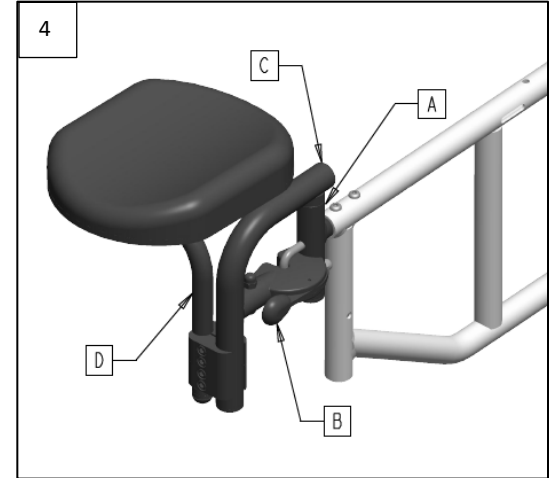

## DUAL ELEVATING LEGREST AND HANGER

5

### 1. Installation

- Position the center pivot of the elevating legrest (C) onto the hanger (A) with the elevating footrest facing out from the wheelchair.
- Swing the elevating legrest inwards such that the swingaway latch (B) 'clicks' into place onto the hanger block.

### 2. Removal

- To remove the elevating legrest, pull up onto the handle latch (B) releasing the mechanism from the U-bolt and hanger. Then swing the elevating legrest outwards or inwards.
- Pull up on legrest to remove from wheelchair.

### 3. Height Adjustment

- Remove bolt (F) which holds the extension tube in place.
- Slide the footrest extension tube up or down to the desired height. Note a minimum of 2" should be kept between the footplate (E) and the floor.
- Re-install and tighten the bolt (F) in place.

### 4. Elevation Adjustment

- Turn the release knob (D) counterclockwise to disengage the ball pin.
- Move the legrest up or down to desired height. Listen for the "clicks" to verify position.
- Turn the release knob (D) clockwise to lock the position.

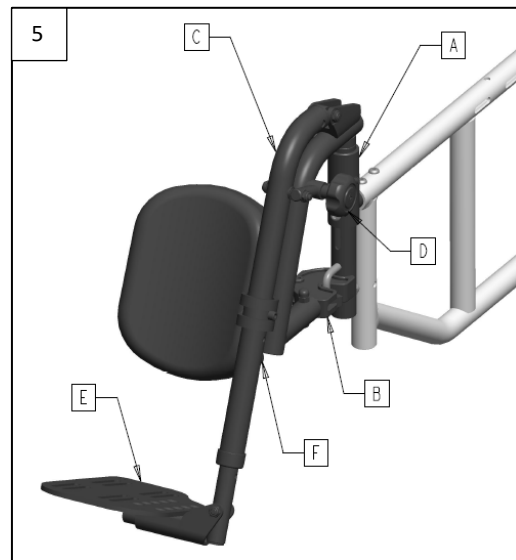

## CASTER AND FORK ASSEMBLY

6A

### 1. Installation of New Caster and Fork

- Remove dust cover (A) from caster housing (D). Gently pry off cover using a back and forth motion with screw driver.
- Caster assembly holds one nut (B) and one washer (immediately below the nut). Remove nut and washer.
- Remove caster fork and stem assembly (E), (F).
- Insert caster stem and fork (E), (F) into caster housing (D) and place washer on stem.
- Replace nut (B) on caster stem and tighten until all play is removed; then loosen approximately  $1/8$  turn, allowing for free rotation.
- Replace dust cover to caster housing.

### 2. Caster Height Adjustment

- Loosen and remove axle bolt from caster (I).
- Set axle at desired height using pre-set holes in the fork.
- Replace and tighten bolt.
- Repeat on other side.

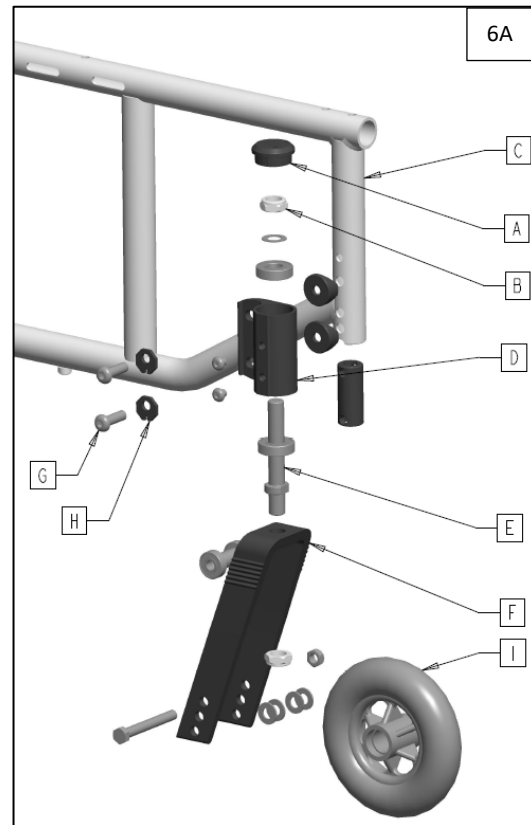

### 3. Caster Fork Angle Adjustment (Rear Facing Position Shown)

6B

For optimum performance, the caster housing should always be at a 90° angle to the floor as shown in fig. 6B. (perpendicular to the ground). This adjustment is made with rotating a notched cam plate (H).

- Loosen bolts (G) from caster housing (D).
- Rotate notched cam plate (H) such that the fork (F) is set to 0°, 3° or 6°. The angle will depend on the seat drop, which is either 0, 1" or 2".
- When the position of the cam plate (H) is set retighten the two retaining bolts (G), fixing the fork in place.
- Repeat for the other side.

### 4. Caster Housing Reversibility

The caster housing is generally mounted in a rear-facing position. If required, the caster housing can be reversed and mounted in the forward-facing position.

- To reverse the caster housing, the left housing should be mounted on the right side of the frame.
- The right housing should be mounted on the left side of the frame.

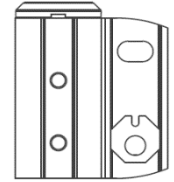
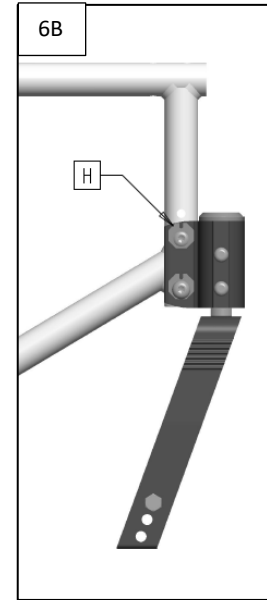

CASTER SET-UP  
FLUSH 0-DEG

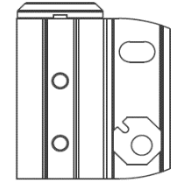

CASTER SET-UP  
1" DROP 3-DEG

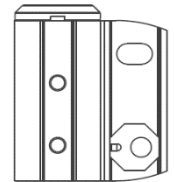

CASTER SET-UP  
2" DROP 3-DEG



## REAR WHEEL AXLE (QUICK RELEASE)

7

### 1. Quick Release Axle Check

Do not use this chair UNLESS you are sure both quick-release axles are locked. An unlocked axle may come off during use and cause a fall.

**Note** – Axle is not locked until the quick-release button (A) pops out fully.

### 2. To Install Rear Wheel

- Depress quick-release button (A) fully. This will release tension on ball bearings at other end.
- Insert axle through hub of rear wheel (B).
- Keep pressure on button (A) as you slide axle (C) into axle sleeve (D).
- Release button to lock axle in sleeve. Adjust axle if it does not lock.
- Repeat steps on other side.

### 3. To Remove Rear Wheel

- Depress quick-release button (A) fully.
- Remove wheel by sliding axle (C) out of axle sleeve (D).
- Repeat steps on other side.

### 4. Rear Wheel Axle Adjustment

Proper axle sleeves adjustment should be maintained for optimum performance of the wheelchair.

- To adjust the axle, you will need a 5/8" wrench to turn the outside axle nut.
- You will also need a 10mm wrench on the opposite end of the axle and prevent the axle from turning.
- Turn the outside axle nut clockwise to tighten.
- There should only be zero to ten thousandths of an inch (.010") of play.

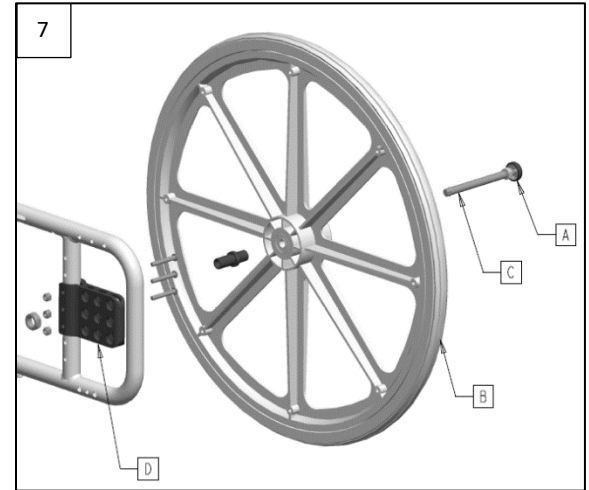

## REAR WHEEL AXLE (FIXED BOLT)

8

### 1. To Install Rear Wheel

- Remove nut and washer (C) from hex bolt (A).
- Insert bolt through hub of rear wheel (B) and spacer.
- Slide bolt (A) into axle sleeve (D).
- Insert washer and nut (C) onto bolt and tighten.
- Repeat steps on other side.

### 2. To Remove Rear Wheel

- Remove nut and washer (C) from hex bolt (A).
- Slide bolt (A) out from axle sleeve (D) keeping spacer on bolt.
- Insert washer and nut (C) back onto bolt for future installation.
- Repeat steps on other side.

### 3. Rear Wheel Axle Adjustment

Proper axle sleeves adjustment should be maintained for optimum performance of the wheelchair.

- To adjust the play in the wheel, turn the nut (C) clock-wise to tighten.
- There should only be zero to ten thousandths of an inch (.010") of play.

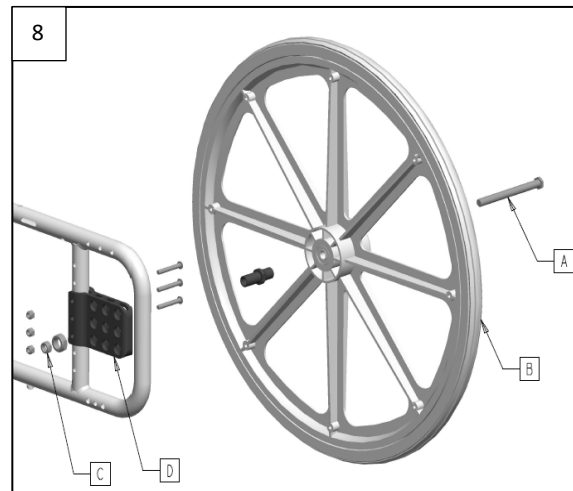

## FRONT SEAT TO FLOOR SET-UP CHART

		STELLATO II (INSIDE/ OUTSIDE RAIL) STF HEIGHT AVAILABILITY									
Flush Seat Slope O.R		Flush Seat Slope I.R		Wheel Size and Axle Position			Fork Position & Caster Wheel Size				
Front STF	Rear STF	Front STF	Rear STF	20"	22"	24"	4"	5"	6"	7"	8"
13.5" FSTF	13.5" RSTF	12" FSTF	12" RSTF	RP1			FP0 SF1				
14.5" FSTF	14.5" RSTF	13" FSTF	13" RSTF	RP2	RP1			FP0 SF2			
15.5" FSTF	15.5" RSTF	14" FSTF	14" RSTF	RP3	RP2	RP1		FP0 MF2	FP0 MF1		
16.5" FSTF	16.5" RSTF	15" FSTF	15" RSTF	RP4	RP3	RP2		FP0 MF4	FP0 MF3	FP0 MF2	
17.5" FSTF	17.5" RSTF	16" FSTF	16" RSTF	RP5	RP4	RP3		FP0 LF4	FP0 LF3	FP0 MF4	FP0 LF1
18.5" FSTF	18.5" RSTF	17" FSTF	17" RSTF	RP6	RP5	RP4		FP1 LF4	FP1 LF3	FP1 MF4	FP0 LF3
19.5" FSTF	19.5" RSTF	18" FSTF	18" RSTF	RP7	RP6	RP5		FP2 LF4	FP2 LF3	FP1 LF4	FP1 LF3
20.5" FSTF	20.5" RSTF	19" FSTF	19" RSTF		RP7	RP6				FP2 LF4	FP2 LF3
		STELLATO II (INSIDE/ OUTSIDE RAIL) STF HEIGHT AVAILABILITY									
1" Drop Seat Slope O.R		1" Drop Seat Slope I.R		Wheel Size and Axle Position			Fork Position & Caster Wheel Size				
Front STF	Rear STF	Front STF	Rear STF	20"	22"	24"	4"	5"	6"	7"	8"
14.5" FSTF	13.5" RSTF	13" FSTF	12" RSTF	RP1				FP0 SF2			
15.5" FSTF	14.5" RSTF	14" FSTF	13" RSTF	RP2	RP1			FP0 MF2	FP0 MF1		
16.5" FSTF	15.5" RSTF	15" FSTF	14" RSTF	RP3	RP2	RP1		FP0 MF4	FP0 MF3	FP0 MF2	
17.5" FSTF	16.5" RSTF	16" FSTF	15" RSTF	RP4	RP3	RP2		FP0 LF4	FP0 LF3	FP0 MF4	FP0 LF1
18.5" FSTF	17.5" RSTF	17" FSTF	16" RSTF	RP5	RP4	RP3		FP1 LF4	FP1 LF3	FP1 MF4	FP0 LF3
19.5" FSTF	18.5" RSTF	18" FSTF	17" RSTF	RP6	RP5	RP4		FP2 LF4	FP2 LF3	FP1 LF4	FP1 LF3
20.5" FSTF	19.5" RSTF	19" FSTF	18" RSTF	RP7	RP6	RP5				FP2 LF4	FP2 LF3

STELLATO II (INSIDE/ OUTSIDE RAIL) STF HEIGHT AVAILABILITY											
2" Drop Seat Slope O.R		2" Drop Seat Slope I.R		Wheel Size and Axle Position			Fork Position & Caster Wheel Size				
Front STF	Rear STF	Front STF	Rear STF	20"	22"	24"	4"	5"	6"	7"	8"
15.5" FSTF	13.5" RSTF	14" FSTF	12" RSTF	RP1				FP0 MF2	FP0 MF1		
16.5" FSTF	14.5" RSTF	15" FSTF	13" RSTF	RP2	RP1			FP0 MF4	FP0 MF3	FP0 MF2	
17.5" FSTF	15.5" RSTF	16" FSTF	14" RSTF	RP3	RP2	RP1		FP0 LF4	FP0 LF3	FP0 MF4	FP0 LF1
18.5" FSTF	16.5" RSTF	17" FSTF	15" RSTF	RP4	RP3	RP2		FP1 LF4	FP1 LF3	FP1 MF4	FP0 LF3
19.5" FSTF	17.5" RSTF	18" FSTF	16" RSTF	RP5	RP4	RP3		FP2 LF4	FP2 LF3	FP1 LF4	FP1 LF3
20.5" FSTF	18.5" RSTF	19" FSTF	17" RSTF	RP6	RP5	RP4				FP2 LF4	FP2 LF3

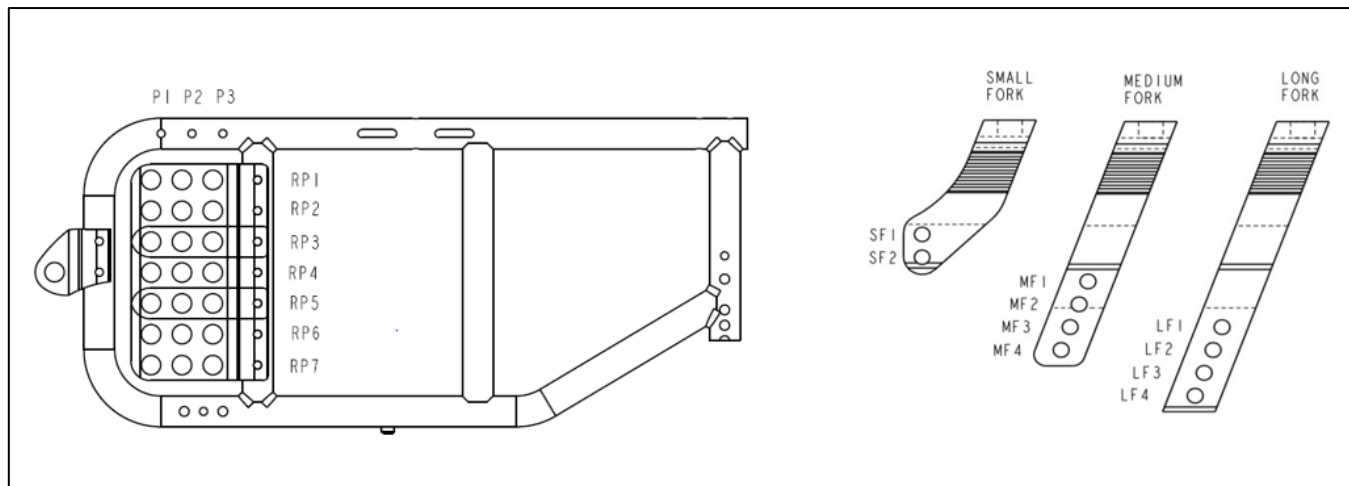

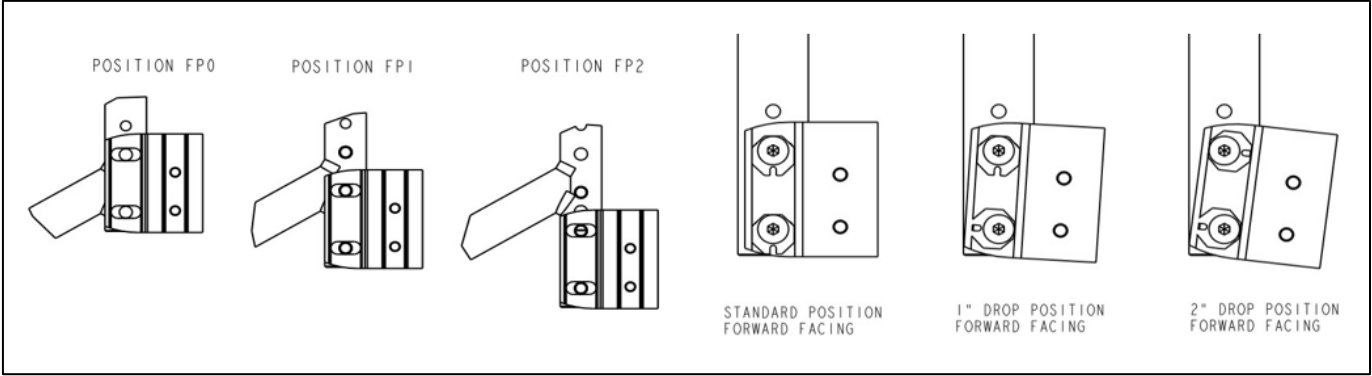

# REAR WHEEL MOUNT POSITION

9

9

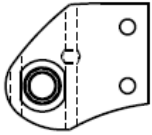

AMPUTEE

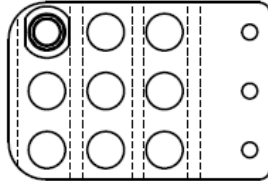

STABLE

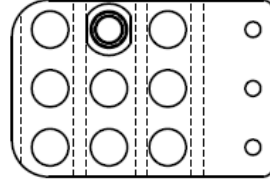

STANDARD

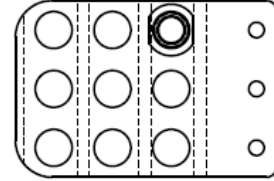

ACTIVE

## FOLDING AND UNFOLDING THE WHEELCHAIR

10

### 1. Folding the Wheelchair

- a. Remove the front swingaway footrests. Refer to swingaway footrest removal on the previous pages.
- b. With both hands, grasp the middle pull strap of the seat upholstery (A) and lift until the seat rail disengages from the saddles (B).
- c. Place excess seat upholstery over the armrest when in the folded position.

### 2. Unfolding the Wheelchair

- a. Press down on the seat rail and the seat upholstery with the entire hand. DO NOT place any part of the hand under the seat rail.
- b. Both seat rails must lock into the seat rail saddles (B) on both side frames.
- c. Replace the front swingaway footrests if required.

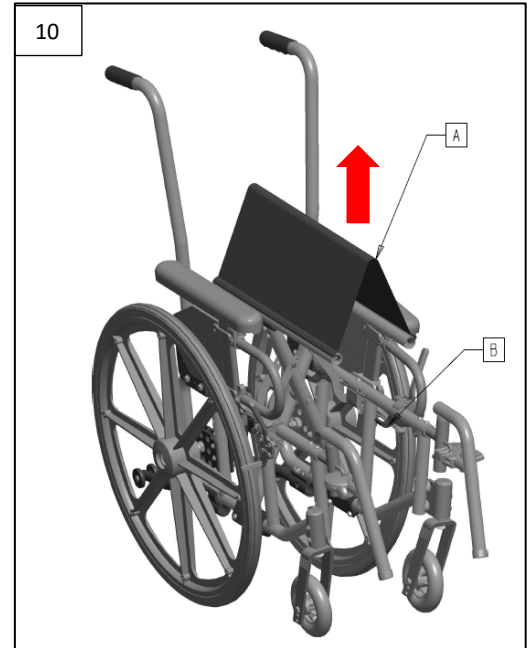

## SEAT SLING

11

The seat sling can be adjusted using hook and loop material beneath the seat. Seat sling also includes a folding strap on the seat to assist in folding the chair.

**NOTE**– The seat sling folding strap is NOT intended as a carrying strap.

### 1. Seat Sling Adjustments

- a. Remove the seat rail end caps (B) at the front of the chair.
- b. Slide the seat sling (A) with plastic retaining rods from the channels in the seat rails.
- c. Readjust hook and loop material underneath the seat sling to obtain the desired tension.
- d. Reinsert the seat sling (A) and plastic retaining rods into the channels in the seat rails.
- e. Replace the end caps.

### 2. Replacing Seat Sling

- a. Remove the seat rail end caps (B) at the front of the chair.
- b. Slide the seat sling (A) with plastic retaining rods from the channels in the seat rails.
- c. Reinsert the new seat sling (A) and plastic retaining rods into the channels in the seat rails.
- d. Replace the end caps.

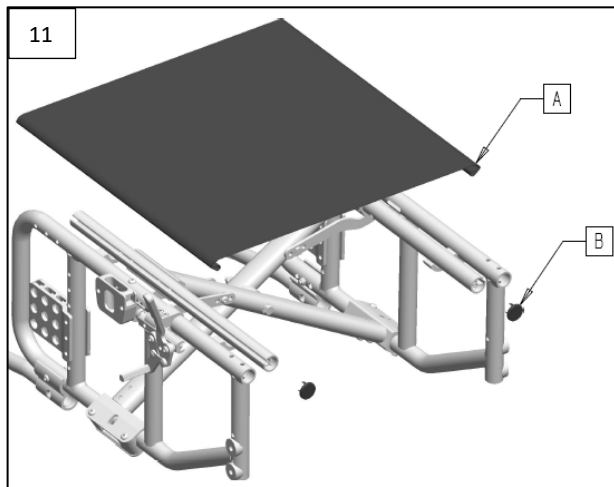



## REAR ANTI-TIPS

12

### 1. Installation of Fixed Anti-tips

The anti-tip tube wheels may have to be raised or lowered to achieve proper ground clearance of (1-1/2" to 2"). Refer to diagram for corresponding tube size to RSTF heights.

- Press release button (A) IN and insert anti-tippers with the anti-tipper wheels pointing toward the ground/ floor into the rear mounting bracket (B) until the release button locks in place.
- Measure the distance between the bottom of the anti-tipper wheels and the ground/ floor.
- If the distance between the bottom of the anti-tipper wheels and the ground/ floor is not 1 ½ and 2-inches, adjust anti-tippers.

### 2. Adjusting Fixed Anti-tips

- Press release button (A) IN and slide the anti-tipper wheel up or down to achieve the 1 ½ to 2-inches clearance.
- Check to make sure that the release buttons are fully engaged in adjustment holes.

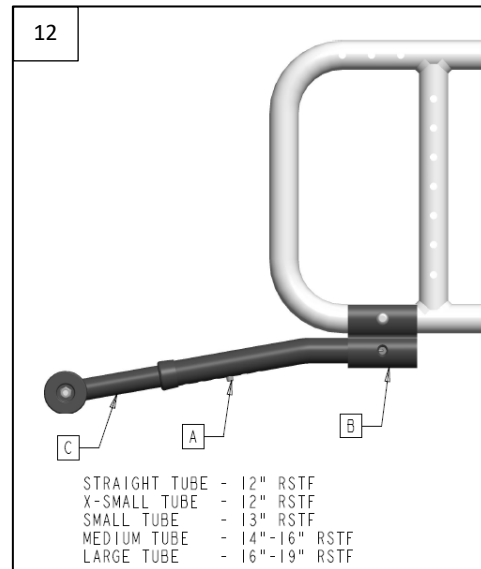

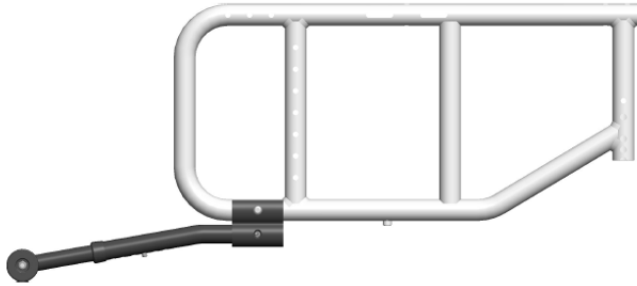

STELLATO II REAR ANTI-TIP CHART	
RSTF	ANTI-TIP
12"	STRAIGHT
12"	X-SMALL
13"	SMALL
14"-16"	MEDIUM
16"-19"	LARGE

1037142 STRAIGHT TUBE

1034559 X-SMALL TUBE

1034560 SMALL TUBE

1034561 MEDIUM TUBE

1034561 LARGE TUBE

SIMPLE ANTI-TIP FAMILY

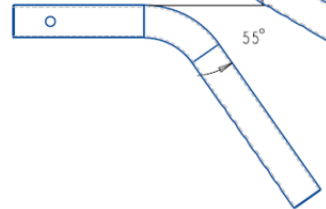
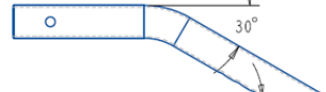
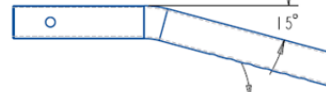
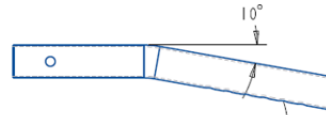

## BACKREST

### 1. Fixed Backrest Angle Adjustment

13A

- a. Loosen and remove bolt (A) from the back rest mounting plate (C).
- b. Position the back rest in the desired location matching the holes in the mounting plate (C).
- c. The center hole is set at 90° and the hole spacing is 7° on either side.
- d. Replace and tighten bolt (A).
- e. Repeat for other side.

**Important Note** – The adjustment on each side of the chair should be exactly equal.

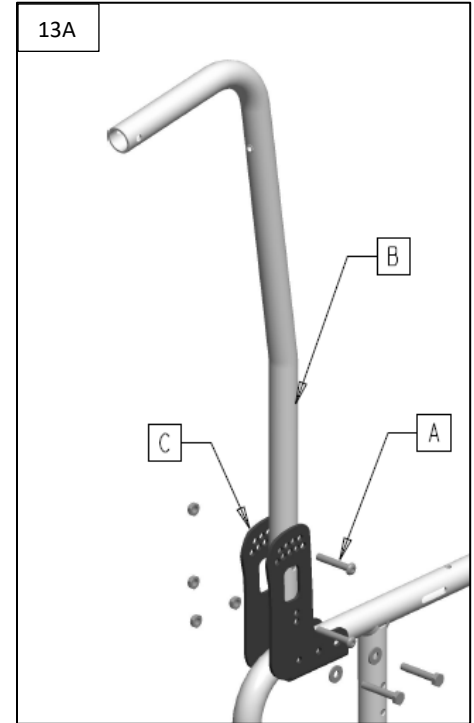

## 1. Flip Down Backrest Angle Adjustment

13B

- a. Loosen and remove bolt (A) from the back rest mounting plate (C).
- b. Position the back rest in the desired location matching the holes in the mounting plate (C).
- c. The center hole is set at 90° and the hole spacing is 7° on either side.
- d. Replace and tighten bolt (A).
- e. Repeat for other side.

**Important Note** – The adjustment on each side of the chair should be exactly equal.

## 2. Flipping Down Backrest

- a. Loosen and remove bolt (A) from the back rest mounting plate (C).
- b. Slide up the device pin (D) on the backrest towards the wheelchair to release the pin engagement.
- c. Rotate the backrest (B) down towards the wheelchair until it touches the side frame.
- d. Repeat for other side.
- e. The same procedure is used to flip the backrest up and make sure the device pins are fully down to lock the vertical position.

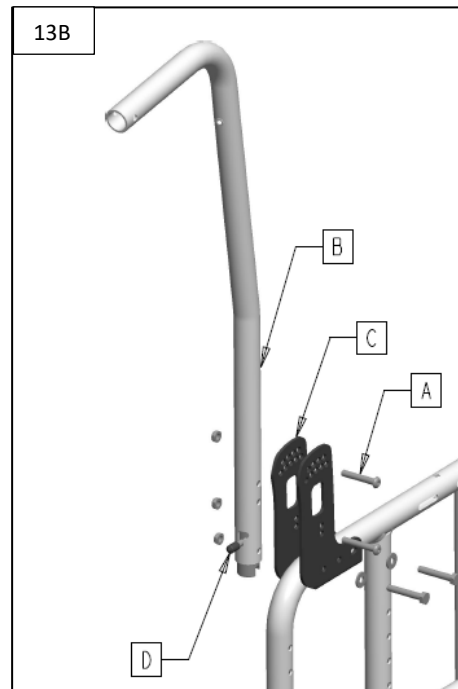

## BACK UPHOLSTERY

14

### 1. Replacing Back Sling

- a. Loosen and remove rear bolts (A) from the mounting plate.
- b. Cut and remove lower tie wraps from the back sling upholstery.
- c. Loosen and remove upper upholstery bolts (B) from the back cane.
- d. Remove the back canes with back upholstery from the chair.
- e. Slide off the backrest upholstery (C) from the back canes.
- f. Slide on the new backrest upholstery and fix in place with upper upholstery bolts (B).
- g. Replace the backrest to the mounting plates matching the holes in the lower support tube.
- h. Replace and tighten bolts (A).
- i. Replace the lower tie wraps.

**Important Note** – The adjustment on each side of the chair should be exactly equal.

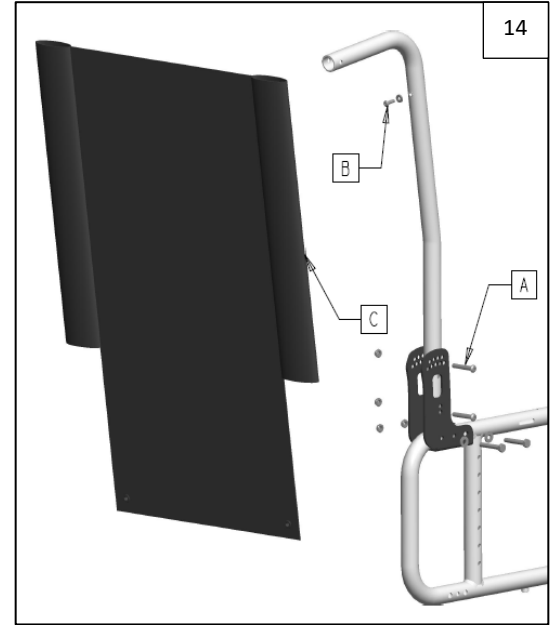

## WHEEL LOCKS

15

### 1. Manual Wheel Lock Function and Adjustment

- a. To adjust, loosen the screws(A) but do not remove them from the bracket (B).
- b. Slide the assembly (E) in the wheel lock mounting bracket (B) (in the activated position) towards the rear wheel tire until the brake shoe (C) embeds into the tire preventing the wheel from turning.
- c. Tighten screws.
- d. To engage wheel lock, push handle (D) forward for the Push to Lock or pull the handle rearward for the Pull to lock version until the mechanism locks in place.

## CUSHION INSTALLATION

- a. Place cushion on seat sling with hook material side down. The pommel of the cushion should be in front.
- b. Press cushion into place.

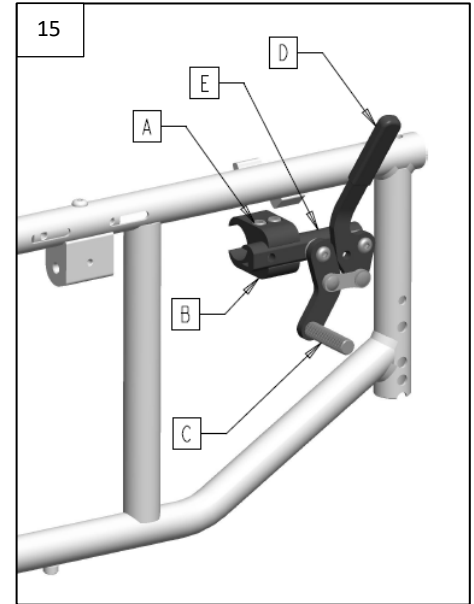

## TIE-DOWNS

16

### 1. Front and Rear Tie-Downs

- a. If possible and feasible, the rider should transfer to the Original Equipment Manufacturer vehicle seat and use the vehicle restraint.
- b. If the wheelchair is used for transport, it must be used in a forward-facing seating position.
- c. The rider must not weigh more than 275 lbs.
- d. Front attachment point (B) and rear attachment point (A)

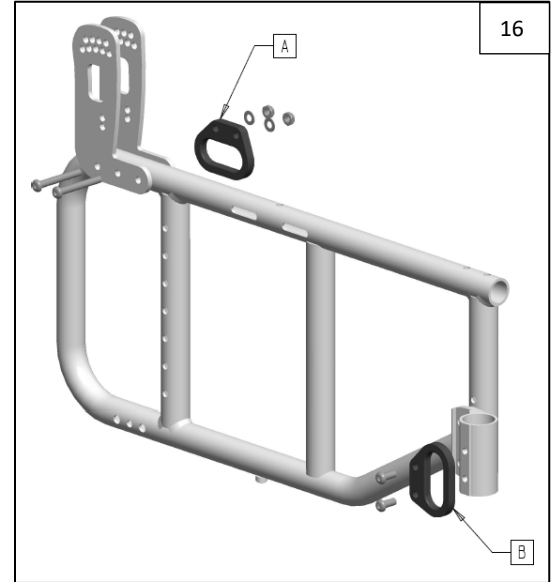

## 10 TROUBLE SHOOTING

You will need to adjust your chair from time to time in order to achieve the best performance (especially if you alter the original settings). This chart gives you a quick look at what might be causing your problem. You may need to look farther to find the best solution for a specific problem.

**NOTE-** To keep track of your progress, make only **ONE** change at a time.

Chair Veers Right/Left	Wheels Drift	Sluggish Turn or Performance	Caster Flutter	Squeaks and Rattles	Looseness in Chair	Solutions
		X	X	X	X	Check for loose nuts and bolts
X	X		X			Check angle adjustable caster assembly
X	X					Check that rear wheels are equally spaced away from seat frame.



## 11 MAINTENANCE

### SAFETY INSPECTION CHECKLIST

Initial adjustments should be made to suit your body structure needs and preference. Please follow these maintenance procedures.

Item	Initially	Weekly	Monthly	Periodically
<b><u>GENERAL</u></b>				
Wheelchair rolls straight (no excessive drag or pull to one side)	X		X	
<b><u>FRAME AND CROSSING TUBES</u></b>				
Inspect for loose or missing hardware	X			X
Inspect for bent frame or cross-tubes	X			X
<b><u>WHEEL LOCKS</u></b>				
Do not interfere with tires when rolling	X		X	
Pivot points free of wear and looseness	X		X	
Wheel locks easy to engage	X			X
Wheel locks prevent chair from moving when engaged	X	X		
<b><u>SEAT AND BACK</u></b>				
Inspect for rips or sagging	X			X
Inspect for loose or broken hardware	X		X	
Inspect cane and hand grips for wear/looseness	X		X	
<b><u>TIRES</u></b>				
Inspect for flat spots, cracks and wear Caution: as with any vehicle, the wheels and tires should be checked periodically for cracks and wear and should be replaced.	X	X		X

<b><u>REAR WHEELS</u></b>				
If equipped, quick-release axles lock properly	X	X		
No excessive side movement or binding when lifted and spun	X			X
Inspect for cracked, bent or broken spokes	X	X		
<b><u>HANDRIMS</u></b>				
Inspect for signs of rough edges or peeling	X			X
<b><u>FRONT CASTERS/FORKS</u></b>				
Inspect caster fork assembly for proper tension by spinning caster; caster should come to a gradual stop	X	X		
Adjust bearing system if wheel wobbles or binds to a stop. Ensure wheel bearings are clean and free of moisture.	X		X	X
Check stem caster journal and lock nut for tightness				
Inspect casters for cracks and wear	X		X	
Inspect for cracked, bent or broken spokes	X			X
	X	X		
<b><u>CLEANING</u></b>				
Clean upholstery and armrests	X			X

## GENERAL MAINTENANCE

1. Maintaining your chair in good working order will keep it functioning properly and help extend the working life of the chair.
2. Clean your chair often.
3. Make sure to replace worn or damaged parts as soon as possible to prevent future injury.
4. It is recommended to have any work done on the chair by an authorized dealer.
5. Follow the safety inspection checklist chart for optimum performance.
6. We recommend that once a year to have a complete inspection, service and safety check of your chair by an authorized dealer.



### **WARNING**

Failing to follow these recommendations could lead to possible injury.

## SERVICE AND REPAIR

1. Please contact the dealership or supplier from where the wheelchair was purchased for service and moderate repair.
2. In some circumstances, it may be necessary to return your wheelchair to Future Mobility for repairs.
3. Contact Future Mobility directly by telephone, fax, or e-mail to obtain information regarding repair at Future Mobility facilities.
4. You will be asked by the Customer Service Representative for the serial number that is affixed to the wheelchair.

5. If any of the following conditions are observed, the wheelchair must be serviced at Future Mobility:
  - e. Any part of the frame is cracked or broken
  - f. Any weld is cracked or broken
6. For safe and secure shipping, the wheelchair must be placed in a suitable carton, or fastened to a pallet, to ensure it does not sustain damage during shipping. Contact Future Mobility to receive specific instructions for packaging and shipping your wheelchair. Alternatively, Future Mobility may arrange for pick-up.

## CLEANING YOUR CHAIR

### **1. Cleaning your Seat and Back**

- a. Remove the outer and inner cover if required and hand wash with a small amount of detergent.
- b. Hang to dry the covers, do not machine dry or wring out.
- c. Use multipurpose disinfectant to spray seat, scrub with soft brush if needed.
- d. Test an inconspicuous area first for color-fastness.
- e. **DO NOT USE HOT AIR FOR DRYING.**
- f. **DO NOT IMMERSE** the cushion or back foam in water or cleaning solution.
- g. Some color leeching from the cover onto the foam is normal and cannot be washed out.

### **5. Paint Finish**

- a. Clean the painted surfaces with mild soap at least once a month

- b. Protect the paint with a coat of non-abrasive auto wax every three months.

**6. Axles and Pivot Joints**

- a. Clean around axles and moving parts WEEKLY with a slightly damp (not wet) cloth.
- b. Wipe off or blow away any dust or dirt on axles or moving parts.



**WARNING**

**Do not use abrasive powders or scouring pads on painted surfaces.**

**Do not ever submerge chair in water.**

**Do not use cleaning products without consulting the products' instructions and taking appropriate precautions for human exposure to chemicals.**

## **12** WARRANTY

### **LIFETIME**

#### **Wheelchair Frame and Cross- Brace**

1. Future Mobility Healthcare Inc. guarantees the frame and cross brace against defects in material and workmanship for life or for as long as the original purchaser owns the chair.
2. This warranty is void if:
  - a. The chair is shown to be abused.
  - b. The chair is not maintained as recommended in the owner's manual.
  - c. The chair is transferred to a different person from the original owner.

### **FOR TWO (2) YEARS**

#### **Wheelchair Back and Cushions (Excluding Upholstery)**

1. Future Mobility Healthcare Inc. guarantees the back and cushion (Excluding Upholstery) to be free of defects in material and workmanship for two years.

#### **Wheelchair Components Excluding Limitations**

1. Future Mobility Healthcare Inc. guarantees the wheelchair components to be free of defects in material and workmanship for two years.

### **FOR (90) DAYS**

#### **Cushion and Back Upholstery**

1. Future Mobility Healthcare Inc. guarantees the wheelchair cushion and back upholstery to be free of defects in material and workmanship for 90 days.

### **LIMITATIONS**

1. We do not warrant:
  - a. Tires, Tubes, Caster Wheels, Push-Handles and Grips.
  - b. Damage from negligence, accident, misuse, or from improper installation or repair.
  - c. Products modified without written consent from FMHI.
  - d. Damage from exceeding the wheelchair weight limit.
2. This warranty is VOID if the original chair serial number label is removed or altered.
3. This warranty is not transferable and only applies to the first consumer purchase of this wheelchair through an authorized Future Mobility Dealer.

## **WARRANTY PROCEDURES**

1. If within this warranty period the product shall be proven to be defective, such product shall be repaired or replaced, at FMHI discretion.
2. FMHI's sole obligation and your exclusive remedy under this warranty shall be limited to the repair and/or replacement of the product or its parts.
3. This warranty does not include any labor or shipping charges incurred in replacement part installation or repair of any product.
4. For warranty service, please contact the dealer from whom you purchased your FMHI product. In the event you do not receive satisfactory warranty service, please write directly to FMHI.
5. DO NOT return products to FMHI without our prior consent. The defective unit or parts must be returned for warranty inspection within thirty (30) days of the return authorization date. (FMHI will issue a return authorization number). Please prepay all shipping charges; C.O.D. shipments will be refused.

The foregoing warranty is exclusive and in lieu of all other expressed warranties. It shall not extend beyond the duration of the expressed warranty provided herein and the remedy for violations of any implied warranty shall be limited to repair or replacement of the defective product pursuant to the terms contained herein. FMHI shall not be liable for any consequential or incidental damages whatsoever.

-----  
Cut below this line #

### **Warranty Registration Form**

To validate your Future Mobility HealthCare warranty, please complete the below form and return it the address at the end of this form. Visit online at [www.futuremobility.ca](http://www.futuremobility.ca) for more Future Mobility Products.

Name: \_\_\_\_\_

Street Address: \_\_\_\_\_

City/Country/Postal Code: \_\_\_\_\_

Telephone: \_\_\_\_\_

Purchased Date: \_\_\_\_\_

Purchased From (Dealer Name & Address): \_\_\_\_\_

Product Purchased: \_\_\_\_\_

Serial Number: \_\_\_\_\_

**Print and Mail it to:**  
**Future Mobility Healthcare Products**  
**6750 Professional Court**  
**Mississauga, Ontario, L4V 1X6**  
**Fax: 905-671-3377**

-----











## **CANADA**

Future Mobility Healthcare Inc.  
6750 Professional Court  
Mississauga, ON L4V 1X6  
Ph: 905 671-1661 – Toll Free: 1 888 737-4011  
Fax: 905 671-3377  
Toll Free Fax: 1-866-670-3377  
e-mail: [customerservice@futureamobility.ca](mailto:customerservice@futureamobility.ca)  
[www.futuremobility.ca](http://www.futuremobility.ca)



**FUTURE MOBILITY**  
INNOVATIVE SEATING AND HOME MOBILITY SOLUTIONS

## **USA**

Future Mobility Products US LLC  
1 Buffalo River Place  
Buffalo, NY, 14210  
Tel: 716-783-9130 – Toll Free 1-855-938-898873  
Fax: 716-783-9236  
Toll Free Fax: 1-866-670-3377  
e-mail: [customerservice@futureamobility.ca](mailto:customerservice@futureamobility.ca)  
[www.futuremobility.ca](http://www.futuremobility.ca)



**FUTURE MOBILITY**  
PRODUCTS

